

# INSTALLATION AND SERVICE MANUAL

**LIGMAN**  
LIGHTING USA

For installation of Mondova recessed exterior downlight  
Model. UMO-80001 , UMO-80011 , UMO-80002 and UMO-80012.

## Product drawing (dimensions)

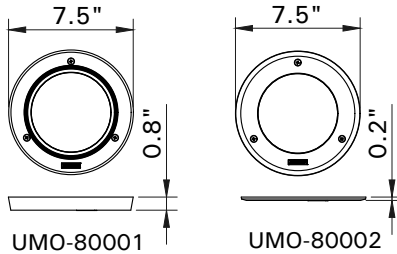

UMO-80001

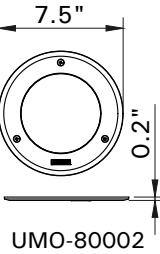

UMO-80011

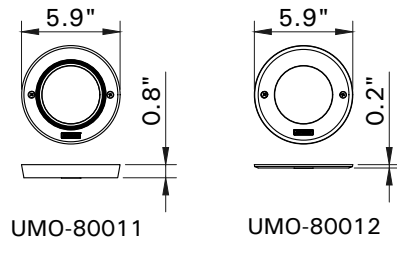

UMO-80012

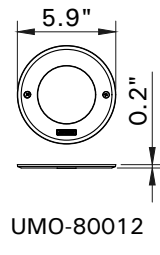

UMO-80012

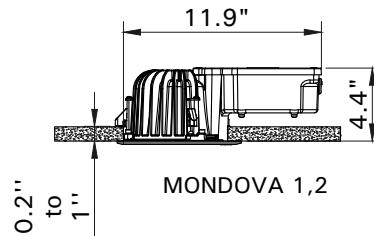

MONDOVA 1,2



MONDOVA 1,2  
Ceilling cut hole Ø 6.9"

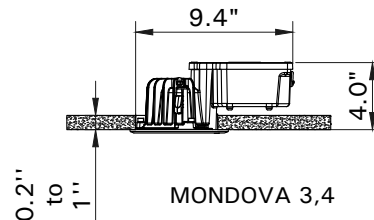

MONDOVA 3,4



MONDOVA 3,4  
Ceilling cut hole Ø 5.5"

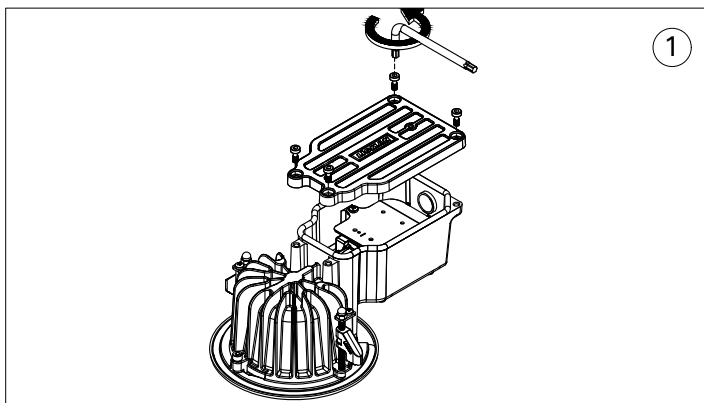

1

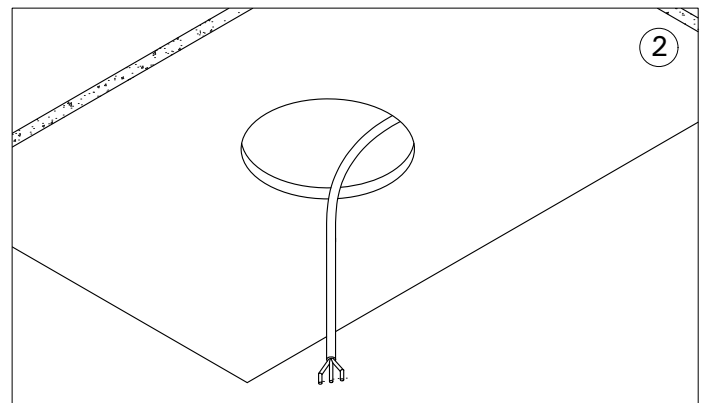

2

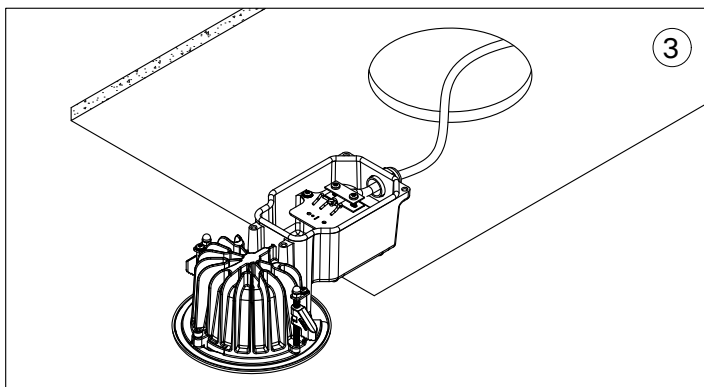

3

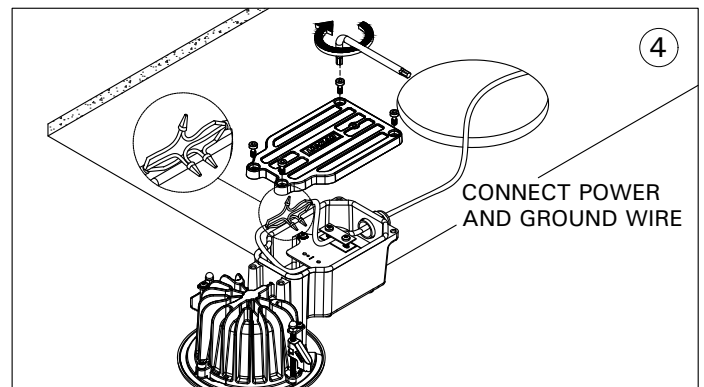

4

CONNECT POWER  
AND GROUND WIRE

## Notice to installer :

**1.WIRING INSTRUCTIONS** Warning : RISK OF FIRE AND ELECTRICAL SHOCK. : FIXTURE MUST BE INSTALLED BY A QUALIFIED ELECTRICIAN ONLY>FIXTURE IS INTENDED FOR INSTALLATION IN ACCORDANCE WITH THE NATIONAL ELECTRICAL CODE, LOCAL AND FEDERAL CODE SPECIFICATIONS. DISCONNECT POWER BEFORE SERVICING.

**2.This fixture has a VOLTAGE SPECIFIC BALLAST,Check that the supply voltage is the same as the installed ballast voltage.**

**Ligman Lighting USA**

7144 NE Progress Court, Hillsboro  
Oregon, 97124, USA  
Tel : 503 645 0500 | Fax : 503 645 8100

www.ligmanlightingusa.com

UMO-80001 28/02/24/REV.1  
1/2

FM-TS-13-1/13-05-2563/Rev.6

