



# Atlantic sheppards crook medium shade post top luminaire

IP55 ✱ ▲ ▲ / EN 60598 / CLASS I Ⓢ / ▽ / CE / IK07



## Suitable for wet locations

A post top luminaire with a medium size shade decorative lantern and symmetrical light distribution and sheppard's crook arm using energy saving compact fluorescent lamps as well as metal halide and high pressure sodium lamps. Developed to compliment the Atlantic sheppard's crook wall light, Atlantic bollard and Atlantic pillar light. Designed for lighting car parks, footpaths, pedestrian areas, precincts, parks, gardens and building perimeters. The LED luminaires have features such as long life, limited maintenance and constant lifetime performance.

Low copper content die-cast aluminium housing with high corrosion resistance. Stainless steel screws. Durable silicone rubber gasket and opal glass diffuser. Housing is treated with a chemical chromatized protection before powder coating, ensuring high corrosion resistance. Integral control gear.

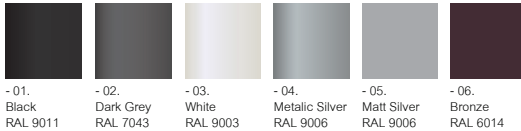

## Product Family





UAA-20161-2-1

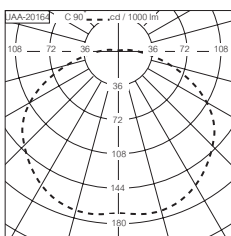
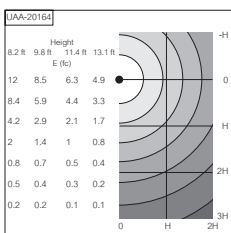
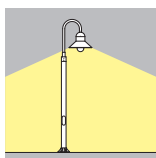

### Atlantic sheppards crook single medium shade post top.

Model No.	Lamp	Holder	Lumen	Weight	Picture
UAA-20161-1-1	CFQ 18w.	G24q-2	1075	50.4 lb.	1
UAA-20162-1-1	CFQ 26w./CFTR 32/42w.	Gx24q-3/4	1550/2040/2720	50.7 lb.	1
UAA-20163-1-1	PMH-ED17 50w.	MED	2100	52.9 lb.	1
UAA-20164-1-1	PMH-ED17 70w.	MED	4000	52.9 lb.	1
UAA-20165-1-1	PMH-ED17 100w.	MED	6500	54.4 lb.	1
UAA-20166-1-1	PMH-ED17 150w.	MED	10000	54.4 lb.	1
UAA-20167-1-1	HPS-ED17 50w.	MED	3600	52.9 lb.	1
UAA-20168-1-1	HPS-ED17 70w.	MED	5450	52.9 lb.	1
UAA-20169-1-1	HPS-ED17 100w.	MED	8550	54.4 lb.	1
UAA-20170-1-1	HPS-ED17 150w.	MED	14400	54.4 lb.	1
UAA-20161-1-2	CFQ 18w.	G24q-2	1075	50.4 lb.	2
UAA-20162-1-2	CFQ 26w./CFTR 32/42w.	Gx24q-3/4	1550/2040/2720	50.7 lb.	2
UAA-20163-1-2	PMH-ED17 50w.	MED	2100	52.9 lb.	2
UAA-20164-1-2	PMH-ED17 70w.	MED	4000	52.9 lb.	2
UAA-20165-1-2	PMH-ED17 100w.	MED	6500	54.4 lb.	2
UAA-20166-1-2	PMH-ED17 150w.	MED	10000	54.4 lb.	2
UAA-20167-1-2	HPS-ED17 50w.	MED	3600	52.9 lb.	2
UAA-20168-1-2	HPS-ED17 70w.	MED	5450	52.9 lb.	2
UAA-20169-1-2	HPS-ED17 100w.	MED	8550	54.4 lb.	2
UAA-20170-1-2	HPS-ED17 150w.	MED	14400	54.4 lb.	2
UAA-20161-2-1	CFQ 18w.	G24q-2	1075	50.4 lb.	3
UAA-20162-2-1	CFQ 26w./CFTR 32/42w.	Gx24q-3/4	1550/2040/2720	50.7 lb.	3
UAA-20163-2-1	PMH-ED17 50w.	MED	2100	52.9 lb.	3
UAA-20164-2-1	PMH-ED17 70w.	MED	4000	52.9 lb.	3
UAA-20165-2-1	PMH-ED17 100w.	MED	6500	54.4 lb.	3
UAA-20166-2-1	PMH-ED17 150w.	MED	10000	54.4 lb.	3
UAA-20167-2-1	HPS-ED17 50w.	MED	3600	52.9 lb.	3
UAA-20168-2-1	HPS-ED17 70w.	MED	5450	52.9 lb.	3
UAA-20169-2-1	HPS-ED17 100w.	MED	8550	54.4 lb.	3
UAA-20170-2-1	HPS-ED17 150w.	MED	14400	54.4 lb.	3
UAA-20161-2-2	CFQ 18w.	G24q-2	1075	50.4 lb.	4
UAA-20162-2-2	CFQ 26w./CFTR 32/42w.	Gx24q-3/4	1550/2040/2720	50.7 lb.	4
UAA-20163-2-2	PMH-ED17 50w.	MED	2100	52.9 lb.	4
UAA-20164-2-2	PMH-ED17 70w.	MED	4000	52.9 lb.	4
UAA-20165-2-2	PMH-ED17 100w.	MED	6500	54.4 lb.	4
UAA-20166-2-2	PMH-ED17 150w.	MED	10000	54.4 lb.	4
UAA-20167-2-2	HPS-ED17 50w.	MED	3600	52.9 lb.	4
UAA-20168-2-2	HPS-ED17 70w.	MED	5450	52.9 lb.	4
UAA-20169-2-2	HPS-ED17 100w.	MED	8550	54.4 lb.	4
UAA-20170-2-2	HPS-ED17 150w.	MED	14400	54.4 lb.	4

### Atlantic sheppards crook single medium shade post top LED.

\*Contact factory for LED  
50w & 90w option available

Model No.	Lamp	Light output	LED colour	Power W	Weight	Picture	Dimmable 1-10v
UAA-20767-1-1-W27	1 LED	1851 lm	2700K	41	68.7 lb.	1	•
UAA-20767-1-1-W30	1 LED	1969 lm	3000K	41	68.7 lb.	1	•
UAA-20767-1-1-W40	1 LED	2372 lm	4000K	41	68.7 lb.	1	•
UAA-20767-1-2-W27	1 LED	1851 lm	2700K	41	68.7 lb.	2	•
UAA-20767-1-2-W30	1 LED	1969 lm	3000K	41	68.7 lb.	2	•
UAA-20767-1-2-W40	1 LED	2372 lm	4000K	41	68.7 lb.	2	•
UAA-20767-2-1-W27	1 LED	1851 lm	2700K	41	68.7 lb.	3	•
UAA-20767-2-1-W30	1 LED	1969 lm	3000K	41	68.7 lb.	3	•
UAA-20767-2-1-W40	1 LED	2372 lm	4000K	41	68.7 lb.	3	•
UAA-20767-2-2-W27	1 LED	1851 lm	2700K	41	68.7 lb.	4	•
UAA-20767-2-2-W30	1 LED	1969 lm	3000K	41	68.7 lb.	4	•
UAA-20767-2-2-W40	1 LED	2372 lm	4000K	41	68.7 lb.	4	•

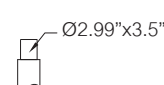
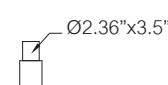
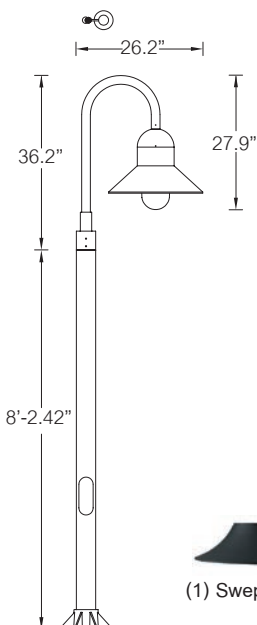

Tenon post top

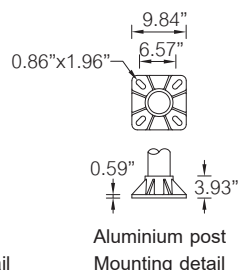
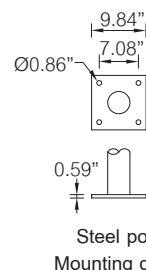
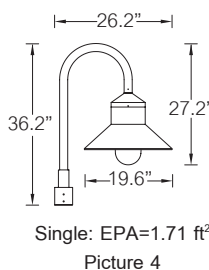
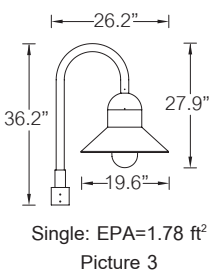
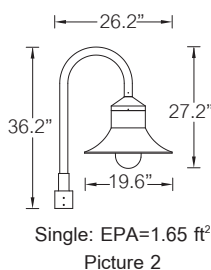
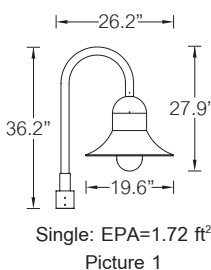

## Atlantic sheppards crook double medium shade post top.

Model No.	Lamp	Holder	Lumen	Weight	Picture
UAA-20171-1-1	CFQ 2x18w.	G24q-2	2X1075	66.5 lb.	1
UAA-20172-1-1	CFQ 2x26w./CFTR 2x32/42w.	Gx24q-3/4	2X1550/2040/2720	67.0 lb.	1
UAA-20173-1-1	PMH-ED17 2x50w.	MED	2X2100	69.2 lb.	1
UAA-20174-1-1	PMH-ED17 2x70w.	MED	2X4000	69.2 lb.	1
UAA-20175-1-1	PMH-ED17 2x100w.	MED	2X6500	70.7 lb.	1
UAA-20176-1-1	PMH-ED17 2x150w.	MED	2X10000	70.7 lb.	1
UAA-20177-1-1	HPS-ED17 2x50w.	MED	2X3600	69.2 lb.	1
UAA-20178-1-1	HPS-ED17 2x70w.	MED	2X5450	69.2 lb.	1
UAA-20179-1-1	HPS-ED17 2x100w.	MED	2X8550	70.7 lb.	1
UAA-20180-1-1	HPS-ED17 2x150w.	MED	2X14400	70.7 lb.	1
UAA-20171-1-2	CFQ 2x18w.	G24q-2	2X1075	66.5 lb.	2
UAA-20172-1-2	CFQ 2x26w./CFTR 2x32/42w.	Gx24q-3/4	2X1550/2040/2720	67.0 lb.	2
UAA-20173-1-2	PMH-ED17 2x50w.	MED	2X2100	69.2 lb.	2
UAA-20174-1-2	PMH-ED17 2x70w.	MED	2X4000	69.2 lb.	2
UAA-20175-1-2	PMH-ED17 2x100w.	MED	2X6500	70.7 lb.	2
UAA-20176-1-2	PMH-ED17 2x150w.	MED	2X10000	70.7 lb.	2
UAA-20177-1-2	HPS-ED17 2x50w.	MED	2X3600	69.2 lb.	2
UAA-20178-1-2	HPS-ED17 2x70w.	MED	2X5450	69.2 lb.	2
UAA-20179-1-2	HPS-ED17 2x100w.	MED	2X8550	70.7 lb.	2
UAA-20180-1-2	HPS-ED17 2x150w.	MED	2X14400	70.7 lb.	2
UAA-20171-2-1	CFQ 2x18w.	G24q-2	2X1075	66.5 lb.	3
UAA-20172-2-1	CFQ 2x26w./CFTR 2x32/42w.	Gx24q-3/4	2X1550/2040/2720	67.0 lb.	3
UAA-20173-2-1	PMH-ED17 2x50w.	MED	2X2100	69.2 lb.	3
UAA-20174-2-1	PMH-ED17 2x70w.	MED	2X4000	69.2 lb.	3
UAA-20175-2-1	PMH-ED17 2x100w.	MED	2X6500	70.7 lb.	3
UAA-20176-2-1	PMH-ED17 2x150w.	MED	2X10000	70.7 lb.	3
UAA-20177-2-1	HPS-ED17 2x50w.	MED	2X3600	69.2 lb.	3
UAA-20178-2-1	HPS-ED17 2x70w.	MED	2X5450	69.2 lb.	3
UAA-20179-2-1	HPS-ED17 2x100w.	MED	2X8550	70.7 lb.	3
UAA-20180-2-1	HPS-ED17 2x150w.	MED	2X14400	70.7 lb.	3
UAA-20171-2-2	CFQ 2x18w.	G24q-2	2X1075	66.5 lb.	4
UAA-20172-2-2	CFQ 2x26w./CFTR 2x32/42w.	Gx24q-3/4	2X1550/2040/2720	67.0 lb.	4
UAA-20173-2-2	PMH-ED17 2x50w.	MED	2X2100	69.2 lb.	4
UAA-20174-2-2	PMH-ED17 2x70w.	MED	2X4000	69.2 lb.	4
UAA-20175-2-2	PMH-ED17 2x100w.	MED	2X6500	70.7 lb.	4
UAA-20176-2-2	PMH-ED17 2x150w.	MED	2X10000	70.7 lb.	4
UAA-20177-2-2	HPS-ED17 2x50w.	MED	2X3600	69.2 lb.	4
UAA-20178-2-2	HPS-ED17 2x70w.	MED	2X5450	69.2 lb.	4
UAA-20179-2-2	HPS-ED17 2x100w.	MED	2X8550	70.7 lb.	4
UAA-20180-2-2	HPS-ED17 2x150w.	MED	2X14400	70.7 lb.	4

## Atlantic sheppards crook double medium shade post top LED.

\*Contact factory for LED  
50w & 90w option available

Model No.	Lamp	Light output	LED colour	Power W	Weight	Picture	Dimmable 1-10v
UAA-20768-1-1-W27	2x1 LED	2X1851 lm	2700K	2x41	68.7 lb.	1	•
UAA-20768-1-1-W30	2x1 LED	2X1969 lm	3000K	2x41	68.7 lb.	1	•
UAA-20768-1-1-W40	2x1 LED	2X2372 lm	4000K	2x41	68.7 lb.	1	•
UAA-20768-1-2-W27	2x1 LED	2X1651 lm	2700K	2x41	68.7 lb.	2	•
UAA-20768-1-2-W30	2x1 LED	2X1969 lm	3000K	2x41	68.7 lb.	2	•
UAA-20768-1-2-W40	2x1 LED	2X2372 lm	4000K	2x41	68.7 lb.	2	•
UAA-20768-2-1-W27	2x1 LED	2X1851 lm	2700K	2x41	68.7 lb.	3	•
UAA-20768-2-1-W30	2x1 LED	2X1969 lm	3000K	2x41	68.7 lb.	3	•
UAA-20768-2-1-W40	2x1 LED	2X2372 lm	4000K	2x41	68.7 lb.	3	•
UAA-20768-2-2-W27	2x1 LED	2X1851 lm	2700K	2x41	68.7 lb.	4	•
UAA-20768-2-2-W30	2x1 LED	2X1969 lm	3000K	2x41	68.7 lb.	4	•
UAA-20768-2-2-W40	2x1 LED	2X2372 lm	4000K	2x41	68.7 lb.	4	•

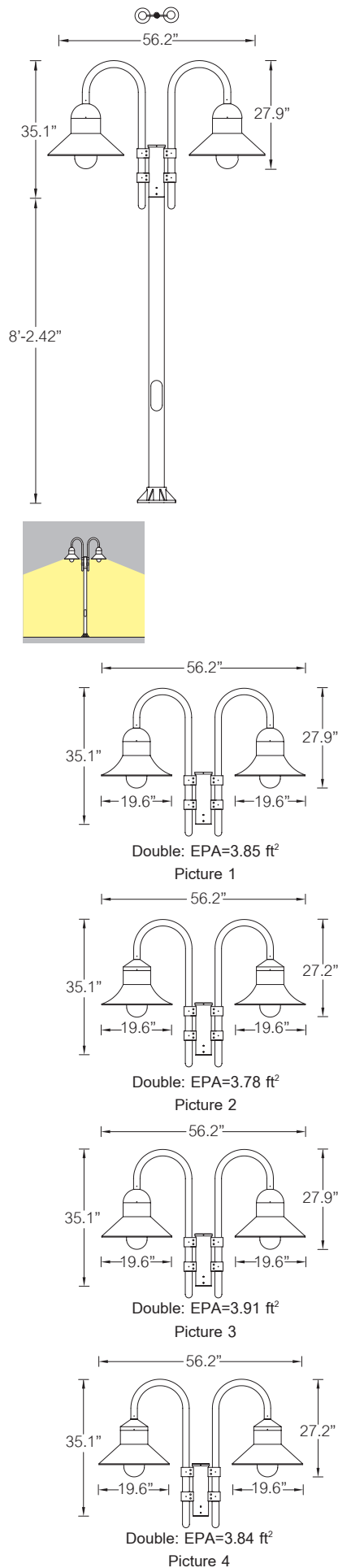

(1) Swept shade

(2) Straight shade

(1) Dome top

(2) Cone top

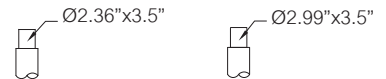

Tenon post top

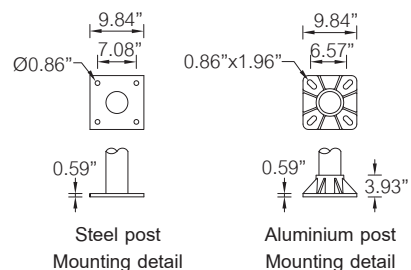

Steel post  
Mounting detail

Aluminium post  
Mounting detail