

For installation of Gino 1,2 wall up-down and down light LED.
Model. UGI-31581 and UGI-31591.

Product drawing (dimensions)

SUITABLE FOR WET LOCATIONS

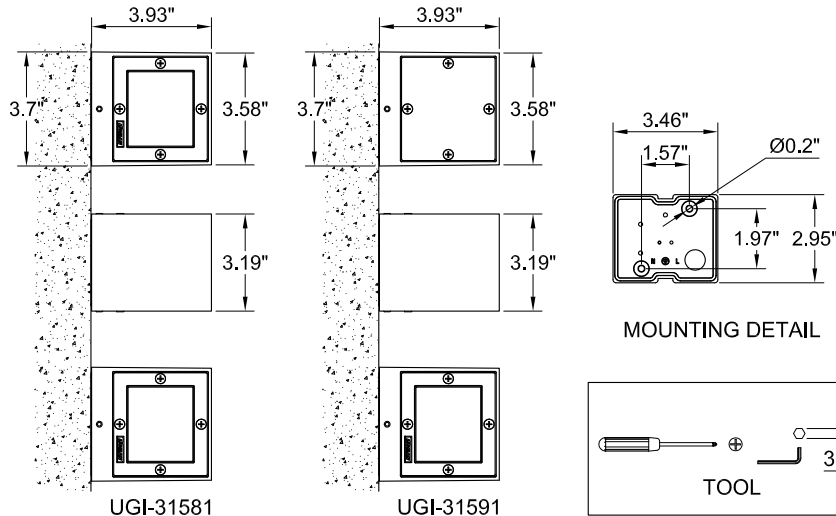

NOTE Mounts over a 3" Octagonal Junction box.

1

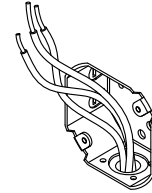

2

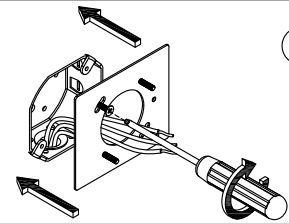

Position the body over the J Box and Secure the back plate to the wall

3

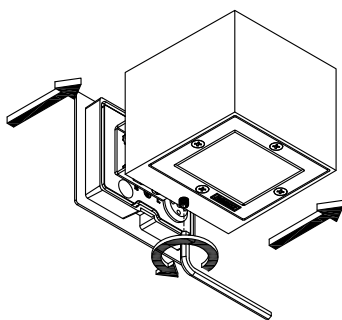

4

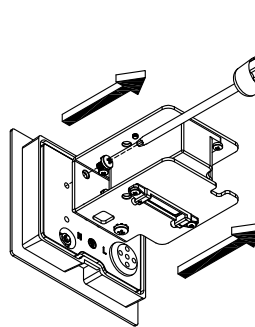

5

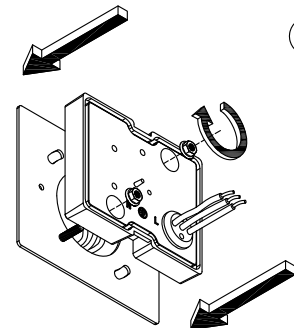

Connect Power and Ground Wire.

6

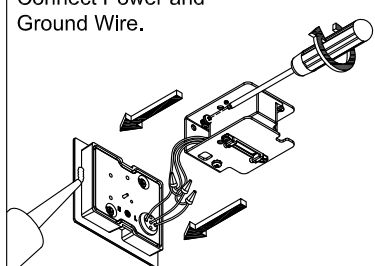

Ensure watertight seal using UL approved silicone based sealant.

7

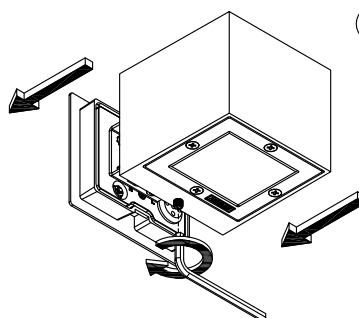

8

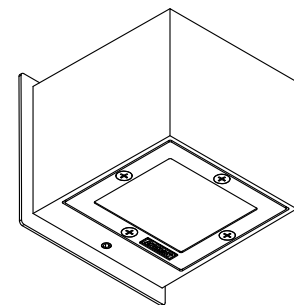

Notice to installer :

- 1.WIRING INSTRUCTIONS** Warning : RISK OF FIRE AND ELECTRICAL SHOCK. : FIXTURE MUST BE INSTALLED BY A QUALIFIED ELECTRICIAN ONLY>FIXTURE IS INTENDED FOR INSTALLATION IN ACCORDANCE WITH THE NATIONAL ELECTRICAL CODE, LOCAL AND FEDERAL CODE SPECIFICATIONS. DISCONNECT POWER BEFORE SERVICING.
- 2.This fixture has a VOLTAGE SPECIFIC BALLAST,Check that the supply voltage is the same as the installed ballast voltage.**

Ligman Lighting USA

7144 NW Progress Court, Hillsboro
Oregon, 97124, USA
Tel : 503 645 0500 | Fax : 503 645 8100

www.ligmanlightingusa.com

UGI-31581/02/09/14/REV.0

1/1



FM-TS-13/25-05-2007-REV.2