

For installation of Abacus 1,2,3 wall light LED.
Model. UAB-30001, 30011 and 30021.

Product drawing (dimensions) SUITABLE FOR WET LOCATIONS

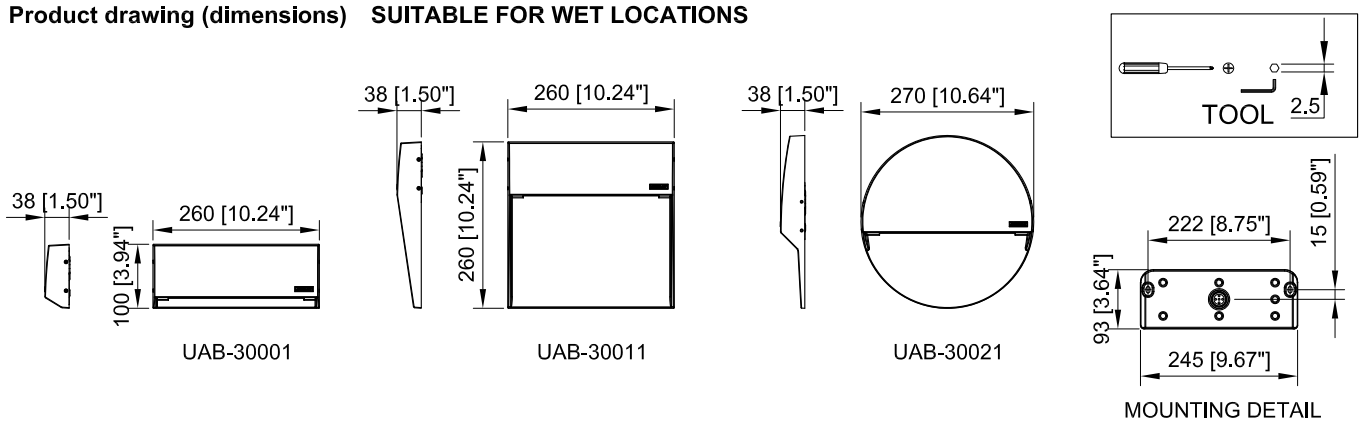

NOTE

Mounts over
a 3" Octagonal
Junction box.

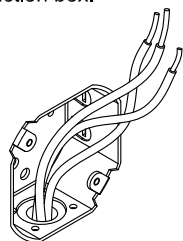

①

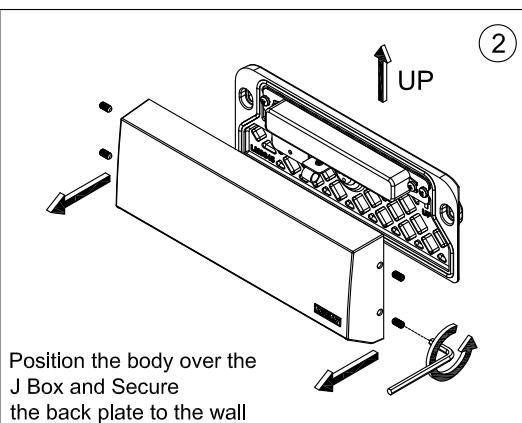

②

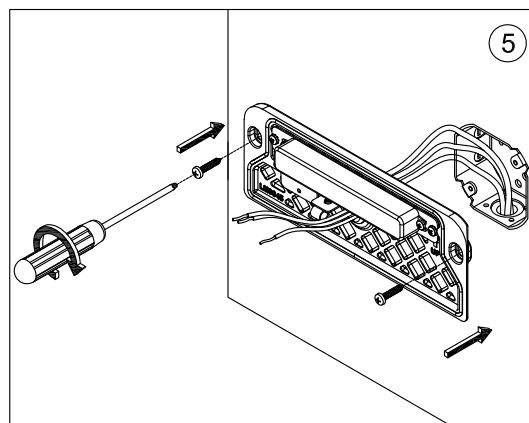

⑤

Connect Power and
Ground Wire.

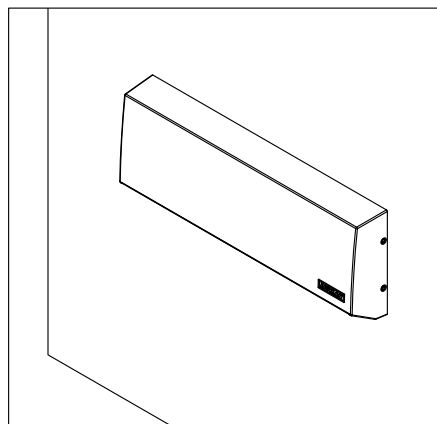
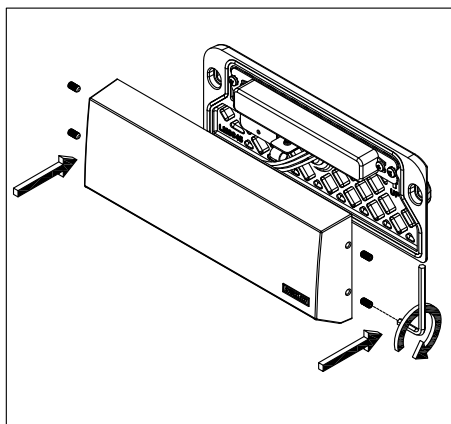
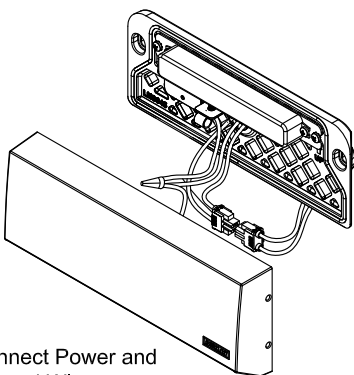

Notice to installer :

- 1.WIRING INSTRUCTIONS** Warning : RISK OF FIRE AND ELECTRICAL SHOCK. : FIXTURE MUST BE INSTALLED BY A QUALIFIED ELECTRICIAN ONLY>FIXTURE IS INTENDED FOR INSTALLATION IN ACCORDANCE WITH THE NATIONAL ELECTRICAL CODE, LOCAL AND FEDERAL CODE SPECIFICATIONS. DISCONNECT POWER BEFORE SERVICING.
- 2.This fixture has a VOLTAGE SPECIFIC BALLAST,**Check that the supply voltage is the same as the installed ballast voltage.

Ligman Lighting USA

7144 NW Progress Court, Hillsboro
Oregon, 97124, USA
Tel : 503 645 0500 | Fax : 503 645 8100

www.ligmanlightingusa.com

UAB-30001 30/01/17/REV.0
1/1



FM-TS-13/25-05-2007-REV.2