



Mustang wall wash light luminaire

IP54 ✱ ⚠ /EN 60598/CLASS I ⚡ /▽/CE/IK07



Suitable for wet locations

Small and medium size rectangular shape wall mounted area light with side throw light distribution for metal halide lamps and high pressure sodium 50-400w. A high quality reflector design creates a broad light distribution. The luminaires are suitable for downward light distribution with adjustable mounting bracket. Designed for lighting footpaths, car parks, building facades, under canopies and roads. The LED luminaires have features such as long life, limited maintenance and constant lifetime performance.

Power is provided through a single PG11 watertight cable gland and 4ft of Outdoor Submersible #18/3 SOOW 600V power cable. Low copper content corrosion resistant aluminum frame and body. Stainless steel screws. Durable silicone rubber gasket and impact resistant toughened glass diffuser with hinged aluminum frame for in-position lamp replacement. The luminaire is treated with a chemical chromated protection before powder coating, ensuring high corrosion resistance. Integral control gear. Anodized high purity 95% reflective aluminum reflector.

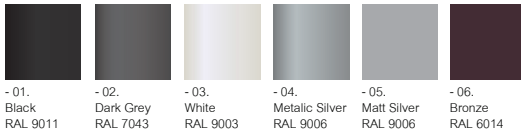

Product Family

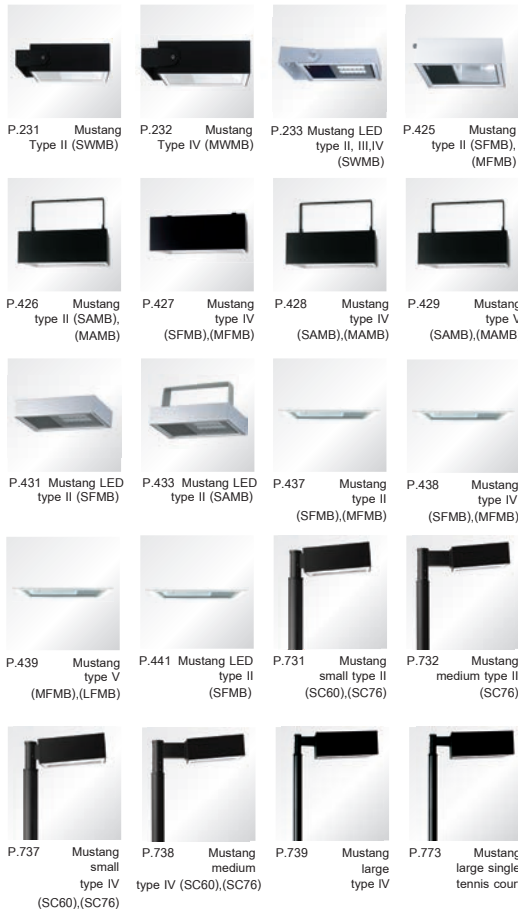



UMS-31133-SWMB

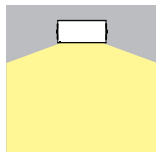

Mustang 1 small wall area light distribution type II

Model No.	Lamp	Holder	Lumen	Weight
UMS-31131-SWMB	PMH-ED17 50w.	MED	2100	21.6 lb.
UMS-31132-SWMB	PMH-ED17 70w.	MED	4000	21.6 lb.
UMS-31133-SWMB	PMH-ED17 100w.	MED	6500	22.0 lb.
UMS-31134-SWMB	PMH-ED17 150w.	MED	10000	22.4 lb.
UMS-31135-SWMB	HPS-ED17 50w.	MED	3600	21.6 lb.
UMS-31136-SWMB	HPS-ED17 70w.	MED	5450	21.6 lb.
UMS-31137-SWMB	HPS-ED17 100w.	MED	8550	22.0 lb.
UMS-31138-SWMB	HPS-ED17 150w.	MED	14400	22.4 lb.

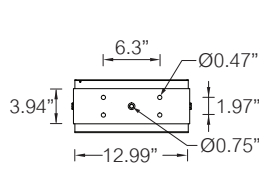

Mounting detail

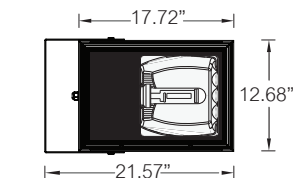

Adjustable

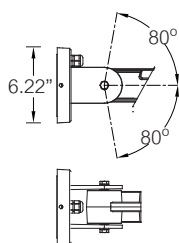

Option: Small adjustable arm

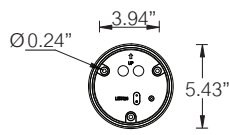

Mounting detail



UMS-32043-MWMB

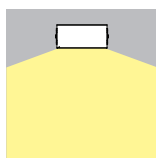

Mustang 2 medium wall area light distribution type II

Model No.	Lamp	Holder	Lumen	Weight
UMS-32041-MWMB	PMH-T15 200w.	MOGUL	19000	30.6 lb.
UMS-32042-MWMB	PMH-T15 250w.	MOGUL	22000	30.6 lb.
UMS-32043-MWMB	PMH-T15 320w.	MOGUL	30000	39.4 lb.
UMS-32044-MWMB	PMH-T15 350w.	MOGUL	31000	39.4 lb.
UMS-32045-MWMB	HPS-ED18 250w.	MOGUL	26100	30.6 lb.
UMS-32046-MWMB	HPS-ED18 400w.	MOGUL	45000	39.4 lb.

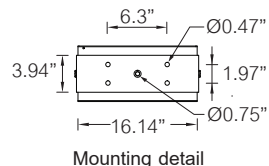

Mounting detail

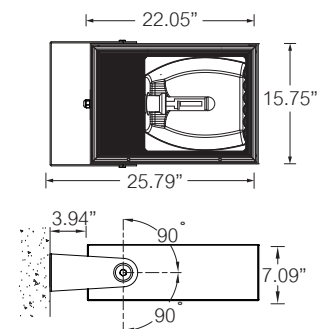

Adjustable

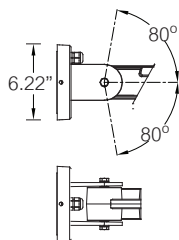

Option: Small adjustable arm

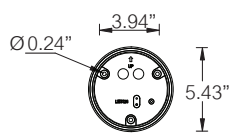

Mounting detail





UMS-31181-SWMB

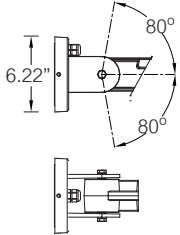
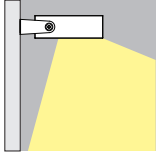

Option: Small adjustable arm

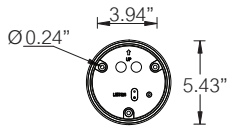

Mounting detail

Mustang 3 small wall area light distribution type IV

Model No.	Lamp	Holder	Lumen	Weight
UMS-31181-SWMB	PMH-ED17 50w.	MED	2100	19.6 lb.
UMS-31182-SWMB	PMH-ED17 70w.	MED	4000	19.6 lb.
UMS-31183-SWMB	PMH-ED17 100w.	MED	6500	19.8 lb.
UMS-31184-SWMB	PMH-ED17 150w.	MED	10000	21.3 lb.
UMS-31185-SWMB	HPS-ED17 50w.	MED	3600	19.6 lb.
UMS-31186-SWMB	HPS-ED17 70w.	MED	5450	19.6 lb.
UMS-31187-SWMB	HPS-ED17 100w.	MED	8550	19.8 lb.
UMS-31188-SWMB	HPS-ED17 150w.	MED	14400	21.3 lb.

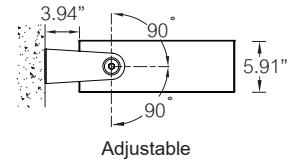
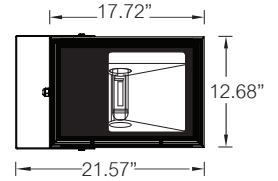
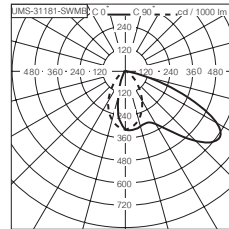
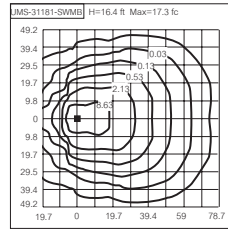

Adjustable

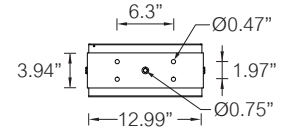

Mounting detail



Mustang 4 medium wall area light distribution type IV

Model No.	Lamp	Holder	Lumen	Weight
UMS-32051-MWMB	PMH-T15 200w.	MOGUL	19000	26.2 lb.
UMS-32052-MWMB	PMH-T15 250w.	MOGUL	22000	26.2 lb.
UMS-32053-MWMB	PMH-T15 320w.	MOGUL	30000	35.0 lb.
UMS-32054-MWMB	PMH-T15 350w.	MOGUL	31000	35.0 lb.
UMS-32055-MWMB	HPS-ED18 250w.	MOGUL	26100	26.2 lb.
UMS-32056-MWMB	HPS-ED18 400w.	MOGUL	45000	35.0 lb.

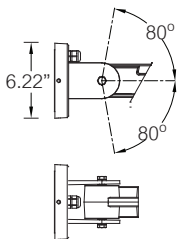
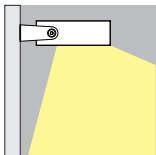

Option: Small adjustable arm

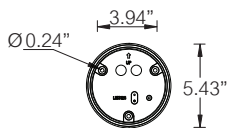

Mounting detail

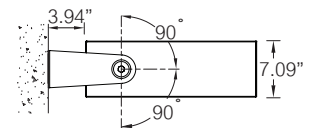
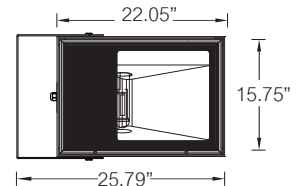
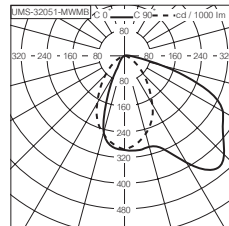
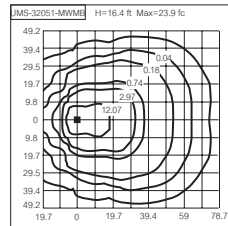

Adjustable

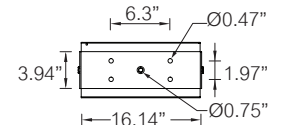

Mounting detail





UMS-31191-SWMB

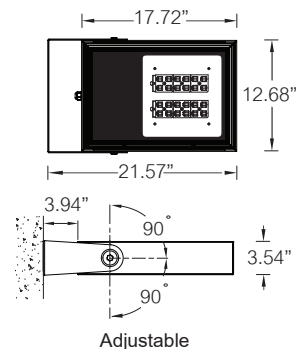
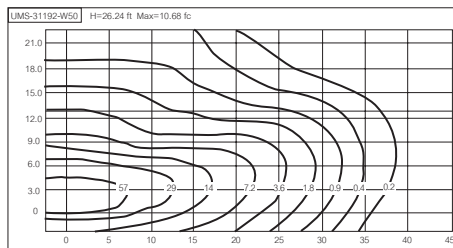
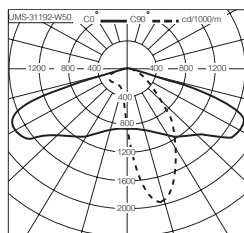
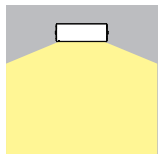

Mustang small LED wall area light distribution type II

Model No.	Lamp	Light output	LED colour	Power W	Weight	Dimmable 1-10V
UMS-31191-SWMB-W30	2X12 LED	2x1561 lm	3000K	2x21	35.7 lb.	•
UMS-31191-SWMB-W40	2X12 LED	2x1587 lm	4000K	2x21	35.7 lb.	•
UMS-31191-SWMB-W50	2X12 LED	2x1655 lm	5000K	2x21	35.7 lb.	•
UMS-31192-SWMB-W30	2X12 LED	2x2043 lm	3000K	2x29	35.7 lb.	•
UMS-31192-SWMB-W40	2X12 LED	2x2049 lm	4000K	2x29	35.7 lb.	•
UMS-31192-SWMB-W50	2X12 LED	2x2150 lm	5000K	2x29	35.7 lb.	•

Mustang small LED wall area light distribution type III

Model No.	Lamp	Light output	LED colour	Power W	Weight	Dimmable 1-10V
UMS-31501-SWMB-W30	2X12 LED	2x1585 lm	3000K	2x21	35.7 lb.	•
UMS-31501-SWMB-W40	2X12 LED	2x1610 lm	4000K	2x21	35.7 lb.	•
UMS-31501-SWMB-W50	2X12 LED	2x1679 lm	5000K	2x21	35.7 lb.	•
UMS-31502-SWMB-W30	2X12 LED	2x2066 lm	3000K	2x29	35.7 lb.	•
UMS-31502-SWMB-W40	2X12 LED	2x2072 lm	4000K	2x29	35.7 lb.	•
UMS-31502-SWMB-W50	2X12 LED	2x2175 lm	5000K	2x29	35.7 lb.	•



UMS-31501-SWMB

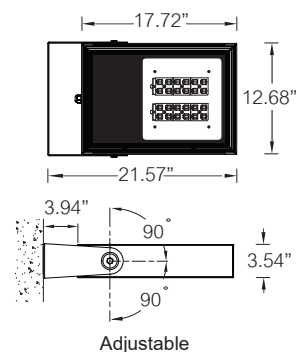
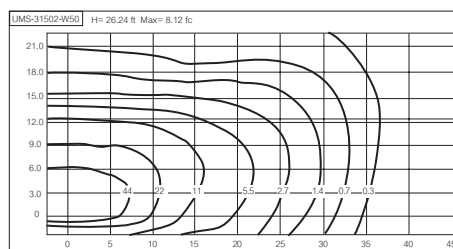
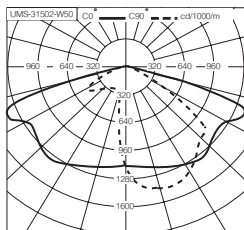
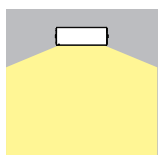

Mustang small LED wall area light distribution type IV

Model No.	Lamp	Light output	LED colour	Power W	Weight	Dimmable 1-10V
UMS-31511-SWMB-W30	2X12 LED	2x1585 lm	3000K	2x21	35.7 lb.	•
UMS-31511-SWMB-W40	2X12 LED	2x1610 lm	4000K	2x21	35.7 lb.	•
UMS-31511-SWMB-W50	2X12 LED	2x1679 lm	5000K	2x21	35.7 lb.	•
UMS-31512-SWMB-W30	2X12 LED	2x2066 lm	3000K	2x29	35.7 lb.	•
UMS-31512-SWMB-W40	2X12 LED	2x2072 lm	4000K	2x29	35.7 lb.	•
UMS-31512-SWMB-W50	2X12 LED	2x2175 lm	5000K	2x29	35.7 lb.	•



UMS-31511-SWMB

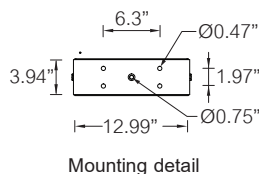
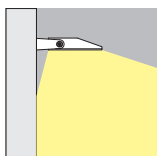

Mounting detail

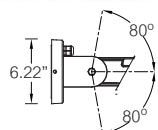
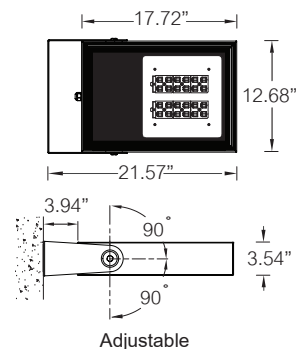

Option: Small adjustable arm

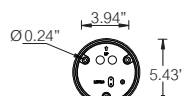

Mounting detail