

IP65 : Suitable for Wet Locations

IK07 : Impact Resistant (Vandal Resistant)

## UAA-30637

### Large Atlantic sheppards crook wall light

A wall mounted outdoor street and amenity lantern with a high performance optical system ensures improved visibility and reduced glare. Designed for pedestrian and residential areas, residential streets, large spaces such as car parks and city center spaces.

Die-cast aluminum housing with high corrosion resistance. Extruded aluminum arm bracket. Stainless steel screws. Durable silicone rubber gasket and clear impact resistant UV stabilized polycarbonate bowl for extra impact resistance. Anodized high purity aluminum cut-off reflector. Housing is treated with a chemical chromated protection before powder coating, ensuring high corrosion resistance. Integral control gear.

#### Physical Data

Length: 37.76"

Height: 42.6"

Weight: 17.6 lbs

#### Lamp

☐ HPS-ED17 150w

(For More Lamp options including LED, please Consult the Catalogue, Website or Contact The Ligman Lighting Factory)

#### Voltage (Please Specify)

☐ 120V  
☐ 277V  
☐ Other \_\_\_\_\_

#### Options (Please Specify)

Color (Please Specify)

☐ 01-Black - RAL 9011 ☐ 02- Dark Grey - RAL 7043  
☐ 03-White - RAL 9003 ☐ 04 - Metallic Silver - RAL 9006  
☐ 05-Matt Silver - RAL 9006 ☐ 07- Custom - RAL \_\_\_\_\_  
☐ 06-Bronze - RAL 6014



#### Shade Style

☐ 1 - Swept Shade ☐ 2 - Straight Shade

#### Top Style

☐ 1 - Dome ☐ 2 - Cone Top

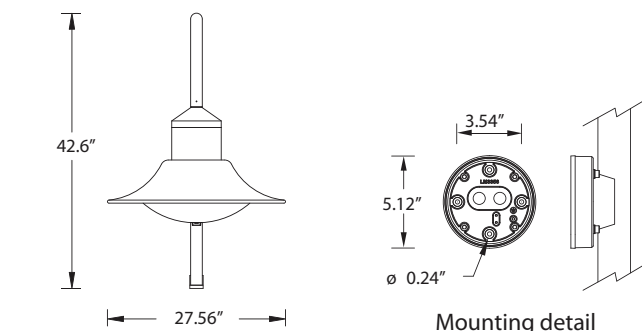
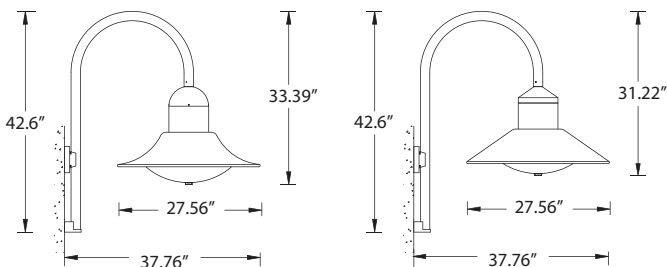
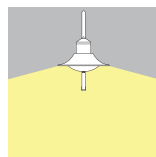

Mounting detail

Ordering Example : UAA - 30637 - HPS-150w - 120v - Options

PROJECT: \_\_\_\_\_ DATE: \_\_\_\_\_

TYPE: \_\_\_\_\_ QUANTITY: \_\_\_\_\_ NOTE: \_\_\_\_\_

Ligman Lighting USA reserves the right to change specifications without prior notice, please contact factory for latest information.  
Due to the continual improvements in LED technology data and components may change without notice.