

IP55 : Suitable for Wet Locations

IK07 : Impact Resistant (Vandal Resistant)



## UDU-30781

### Duomo wall light

A decorative cylindrical shape wall lantern with symmetrical light distribution.

Developed to compliment the Duomo bollard and Duomo pillar light. Designed for lighting of entrances, footpaths and car parks.

Low copper content die-cast aluminum housing with high corrosion resistance.

Stainless steel screws. Durable silicone rubber gasket and opal glass diffuser. Housing is treated with a chemical chromated protection before powder coating, ensuring high corrosion resistance. Integral control gear.

#### Physical Data

Length: 6.3"

Height: 19.06"

Weight: 14.9 lbs

#### Lamp

☐ CFQ 18w

(For More Lamp options including LED, please Consult the Catalogue, Website or Contact The Ligman Lighting Factory)

#### Voltage (Please Specify)

☐ 120V

☐ 277V

☐ Other \_\_\_\_\_

#### Options (Please Specify)

##### Color (Please Specify)

☐ 01-Black - RAL 9011

☐ 03-White - RAL 9003

☐ 05-Matt Silver - RAL 9006

☐ 06-Bronze - RAL 6014

☐ 02- Dark Grey - RAL 7043

☐ 04 - Metallic Silver - RAL 9006

☐ 07- Custom - RAL \_\_\_\_\_

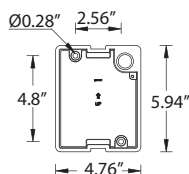
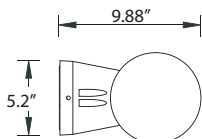
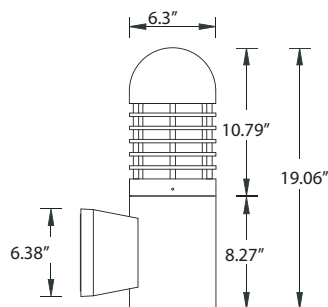
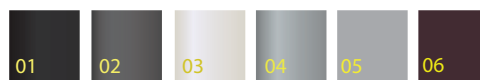

Mounting detail

#### Top Style



☐ 1 - Dome



☐ 2 - Flat

☐ EMR- Remote Battery Pack

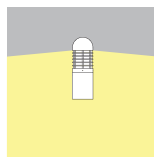

Ordering Example : UDU - 30781 - CFQ-18w - 120v - Options



Rev: 11/13

PROJECT: \_\_\_\_\_ DATE: \_\_\_\_\_

TYPE: \_\_\_\_\_ QUANTITY: \_\_\_\_\_ NOTE: \_\_\_\_\_

Ligman Lighting USA reserves the right to change specifications without prior notice, please contact factory for latest information.  
Due to the continual improvements in LED technology data and components may change without notice.

