

For installation of Duomo wall light.
Model. UDU-30781-30786.

Product drawing (dimensions)

SUITABLE FOR WET LOCATIONS

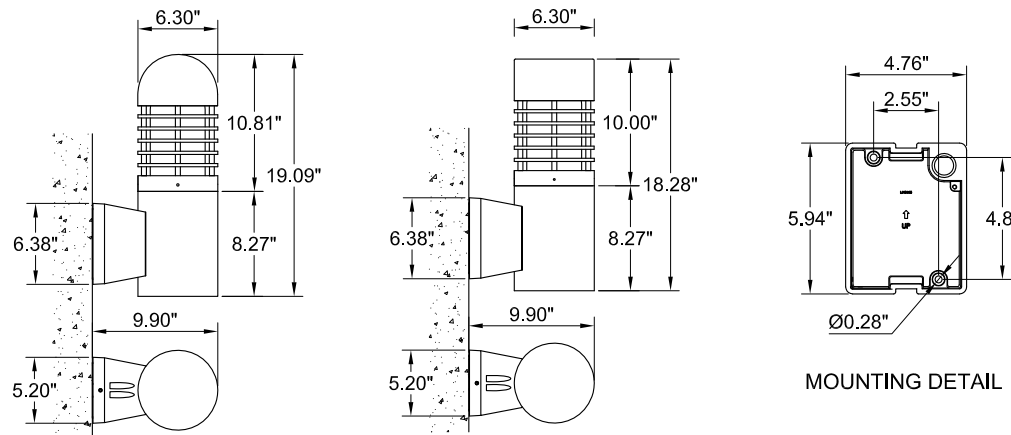

MOUNTING DETAIL

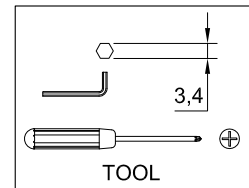

NOTE

Mounts over a 3" Octagonal Junction box.

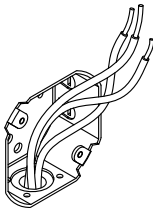

1

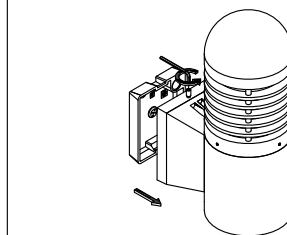

2

Center the Back Plate over the J Box and Secure the back plate to the wall

3

Ensure watertight seal using UL approved silicone based sealant.

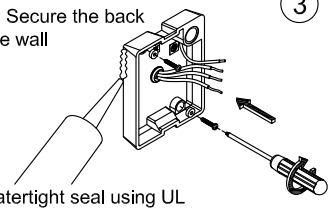

4

Connect Power and Ground Wire.

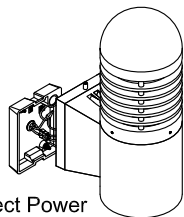

5

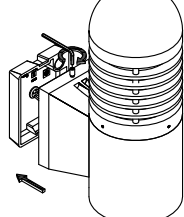

6

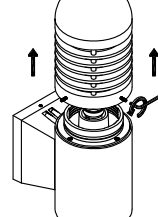

Install lamp

7

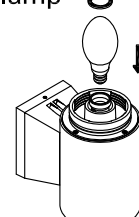

8

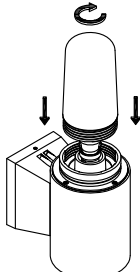

9

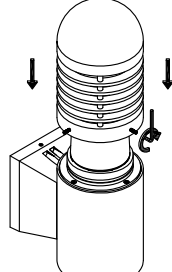

10

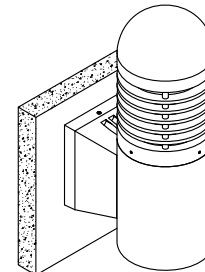

Notice to installer :

- 1.WIRING INSTRUCTIONS Warning : RISK OF FIRE AND ELECTRICAL SHOCK. : FIXTURE MUST BE INSTALLED BY A QUALIFIED ELECTRICIAN ONLY>FIXTURE IS INTENDED FOR INSTALLATION IN ACCORDANCE WITH THE NATIONAL ELECTRICAL CODE, LOCAL AND FEDERAL CODE SPECIFICATIONS. DISCONNECT POWER BEFORE SERVICING.**
- 2.This fixture has a VOLTAGE SPECIFIC BALLAST,Check that the supply voltage is the same as the installed ballast voltage.**

Ligman Lighting USA

7144 NW Progress Court, Hillsboro
Oregon, 97124, USA
Tel : 503 645 0500 | Fax : 503 645 8100

www.ligmanlightingusa.com

UDU-30781/15/07/14/REV.1
1/1



FM-TS-13/25-05-2007-REV.2