

IP54 : Suitable for Wet Locations

IK07 : Impact Resistant (Vandal Resistant)

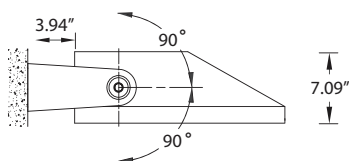

Adjustable

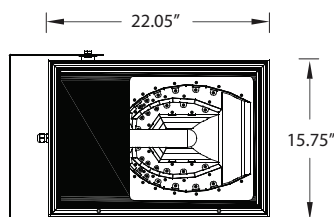
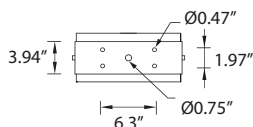

Mounting detail

UMN-32034

Martini 28 medium area light

Small and medium size modern shape wall area light with asymmetrical forward throw light distribution for metal halide lamps or high pressure sodium lamps 70-400w. A high quality reflector design creates broad spread light distribution. The luminaires are suitable downward light distribution with adjustable arm and aluminum housing with high corrosion resistance. Single cable entry PG 11 waterproof gland. Integral control gear. Stainless steel screws. Durable silicone rubber gasket and clear toughened glass with hinged aluminum frame for in-position lamp replacement. Anodized high purity aluminum reflector.

Physical Data

Length: 22.05"

Height: 7.09"

Weight: 38.1 lbs

Lamp

☐ PMH-T15 320w 

(For More Lamp options including LED, please Consult the Catalogue, Website or Contact The Ligman Lighting Factory)

Voltage (Please Specify)

☐ 120V
☐ 277V
☐ Other _____

Options (Please Specify)

☐ F - Frosted Lens
☐ C - Clear Lens

Color (Please Specify)

☐ 01-Black - RAL 9011
☐ 03-White - RAL 9003
☐ 05-Matt Silver - RAL 9006
☐ 06-Bronze - RAL 6014
☐ 02- Dark Grey - RAL 7043
☐ 04 - Metallic Silver - RAL 9006
☐ 07- Custom - RAL _____

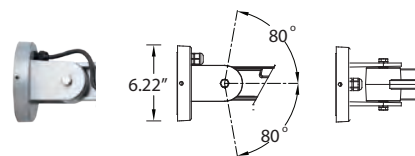

☐ SAM - Small Adjustable Arm

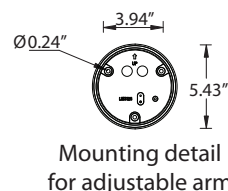

Mounting detail
for adjustable arm

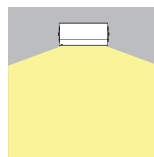

Ordering Example : UMN - 32034 - PMH-320w - 120v - Options

PROJECT: _____ DATE: _____

TYPE: _____ QUANTITY: _____ NOTE: _____

Ligman Lighting USA reserves the right to change specifications without prior notice, please contact factory for latest information.
Due to the continual improvements in LED technology data and components may change without notice.