

IP54 : Suitable for Wet Locations

IK07 : Impact Resistant (Vandal Resistant)

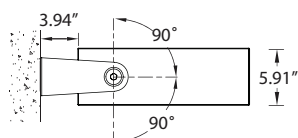

Adjustable

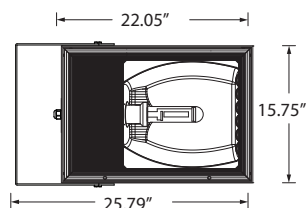
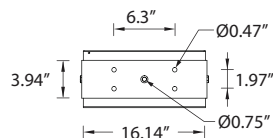

Mounting detail

## UMS-32046-MWMB

### Mustang 2 medium wall area light Type II

Small and medium size rectangular shape wall mounted area light with cut-off light distribution for metal halide lamps high pressure sodium 70-400w and LED. A high quality reflector design creates a broad light distribution. The luminaires are suitable for downward light distribution with adjustable mounting bracket. Designed for lighting footpaths, car parks, building facades, under canopies and roads.

Power is provided through a single PG11 watertight cable gland and 4ft of outdoor submersible #18/3 SOOW 600V power cable. Low copper content corrosion resistant die-cast aluminum frame and body. Stainless steel screws. Durable silicone rubber gasket and impact resistant toughened glass diffuser with hinged aluminum frame for in-position lamp replacement. The luminaire is treated with a chemical chromated protection before powder coating, ensuring high corrosion resistance. Integral control gear. Anodized high purity 95% reflective aluminum reflector.

#### Physical Data

Length: 25.79"

Height: 5.91"

Weight: 30.6 lbs

#### Lamp

☐ HPS-ED18 400w 

(For More Lamp options including LED, please Consult the Catalogue, Website or Contact The Ligman Lighting Factory)

#### Voltage (Please Specify)

- ☐ 120V  
☐ 277V  
☐ Other \_\_\_\_\_

#### Options (Please Specify)

- ☐ F - Frosted Lens  
☐ C - Clear Lens

#### Color (Please Specify)

- ☐ 01-Black - RAL 9011  
☐ 03-White - RAL 9003  
☐ 05-Matt Silver - RAL 9006  
☐ 06-Bronze - RAL 6014  
☐ 02- Dark Grey - RAL 7043  
☐ 04 - Metallic Silver - RAL 9006  
☐ 07- Custom - RAL \_\_\_\_\_

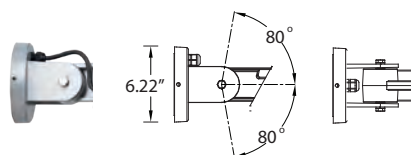
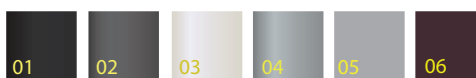

☐ SAM - Small Adjustable Arm

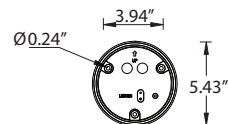

Mounting detail  
for adjustable arm

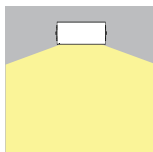

Ordering Example : UMS - 32046 - HPS-400w - 120v - Options

PROJECT: \_\_\_\_\_ DATE: \_\_\_\_\_

TYPE: \_\_\_\_\_ QUANTITY: \_\_\_\_\_ NOTE: \_\_\_\_\_

Ligman Lighting USA reserves the right to change specifications without prior notice, please contact factory for latest information.  
Due to the continual improvements in LED technology data and components may change without notice.