



Cinati wall washer

IP65 ✱ ▲ ▲/EN 60598/CLASS I Ⓢ / ▽ / CE / IK07



Suitable for wet locations

A range of geometric shape wall washer luminaires. Suitable for outdoor downlighting applications and up-lighting applications using energy saving compact fluorescent lamps and LED. The LED luminaires have features such as long life, limited maintenance and constant lifetime performance.



Low copper content corrosion resistant die-cast aluminum frame and body. Stainless steel screws. Durable silicone rubber gasket and impact resistant frosted toughened glass diffuser. The luminaire is treated with a chemical chromated protection before powder coating, ensuring high corrosion resistance. Integral control gear. To maintain the integrity of the IP rating of this luminaire it is supplied with a specially designed SHG self sealing wiring grommet that is used when connecting to the power supply. This grommet insures that water and dust does not enter the luminaire through the knockout hole in the back of the luminaire.

Dark sky compliant.

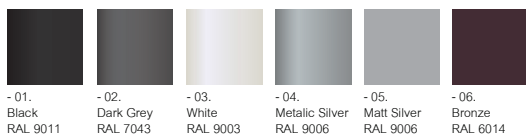



UCI-30112

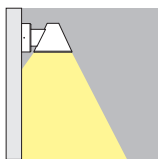

Cinati wall washer

Model No.	Lamp	Holder	Lumen	Weight
UCI-30111	CFTR 13w.	Gx24q-1	775	6.3 lb.
UCI-30112	CFTR 18w.	Gx24q-2	1020	6.3 lb.

Cinati wall washer LED

Model No.	Lamp	Light output	LED colour	Power W	Weight	Dimmable 1-10V
UCI-30114-N-W27	12 LED	979 lm	2700K	20	6.1 lb.	-
UCI-30114-N-W30	12 LED	1041 lm	3000K	20	6.1 lb.	-
UCI-30114-N-W40	12 LED	1062 lm	4000K	20	6.1 lb.	-
UCI-30114-M-W27	12 LED	1084 lm	2700K	20	6.1 lb.	-
UCI-30114-M-W30	12 LED	1153 lm	3000K	20	6.1 lb.	-
UCI-30114-M-W40	12 LED	1176 lm	4000K	20	6.1 lb.	-
UCI-30114-W-W27	12 LED	1016 lm	2700K	20	6.1 lb.	-
UCI-30114-W-W30	12 LED	1081 lm	3000K	20	6.1 lb.	-
UCI-30114-W-W40	12 LED	1102 lm	4000K	20	6.1 lb.	-

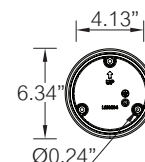
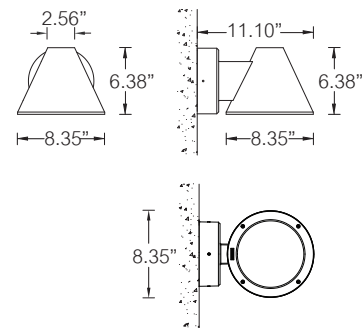
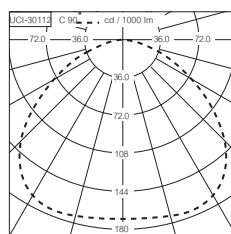
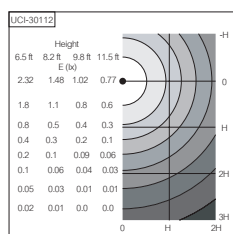

Mounting detail