

For installation of Tango 4,14 cylindrical and square wall down light
Model. UTA-30391-30396 and UTA-30751-30756.

Product drawing (dimensions)

SUITABLE FOR WET LOCATIONS

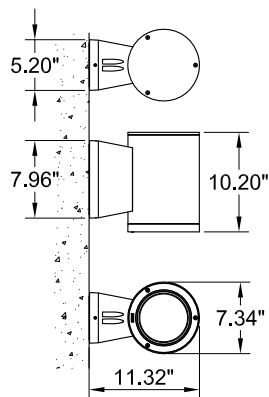

UTA-30391-30396

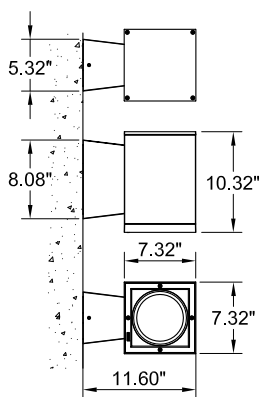

UTA-30751-30756

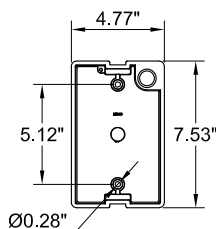

MOUNTING DETAIL

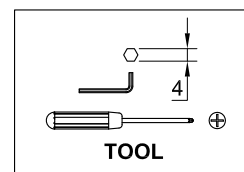

TOOL

NOTE
Mounts over
a 3" Octagonal
Junction box.

①

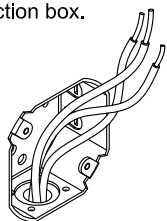

②

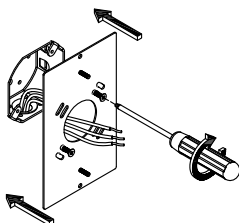

③

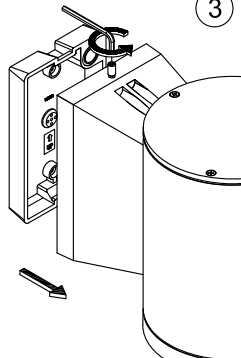

Center the Back
Plate over the J Box
and Secure the back plate
to the wall

④

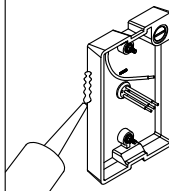

Ensure watertight seal
using UL approved
silicone based sealant.

⑤

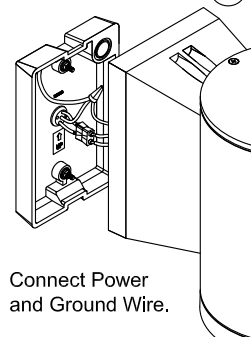

Connect Power
and Ground Wire.

⑥

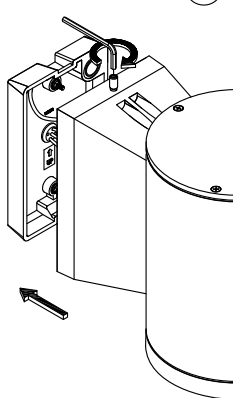

⑦

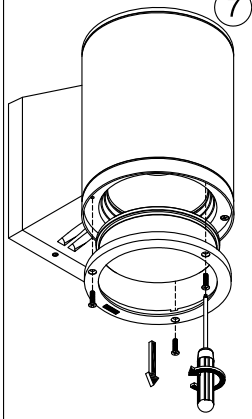

⑧

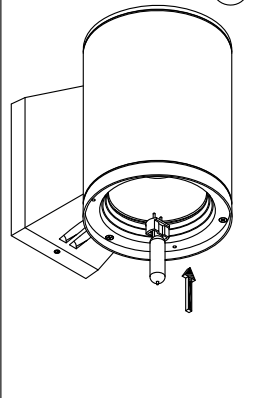

⑨

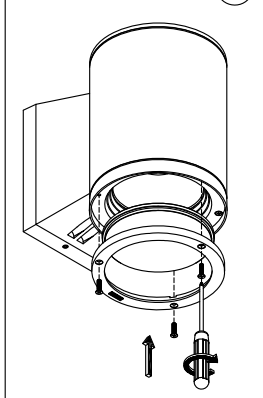

⑩

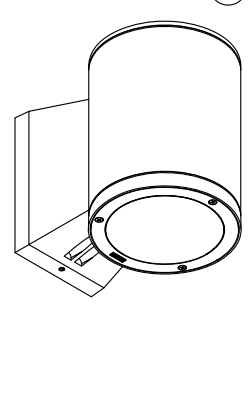

Notice to installer :

- 1.WIRING INSTRUCTIONS** Warning : RISK OF FIRE AND ELECTRICAL SHOCK. : FIXTURE MUST BE INSTALLED BY A QUALIFIED ELECTRICIAN ONLY>FIXTURE IS INTENDED FOR INSTALLATION IN ACCORDANCE WITH THE NATIONAL ELECTRICAL CODE, LOCAL AND FEDERAL CODE SPECIFICATIONS. DISCONNECT POWER BEFORE SERVICING.
- 2.This fixture has a VOLTAGE SPECIFIC BALLAST,Check that the supply voltage is the same as the installed ballast voltage.**

Ligman Lighting USA

7144 NW Progress Court, Hillsboro
Oregon, 97124, USA
Tel : 503 645 0500 | Fax : 503 645 8100

www.ligmanlightingusa.com

UTA-30391/13/06/14/REV.2

1/1

ISO 9001
ISO 14001
BUREAU VERITAS
Certification



FM-TS-13/25-05-2007-REV.2