

INSTALLATION AND SERVICE MANUAL

LIGMAN
LIGHTING USA

For Installation of LED Module Assembly - ULE-40611 - (Legend Recessed - 48 LED)

Product drawing (dimensions)

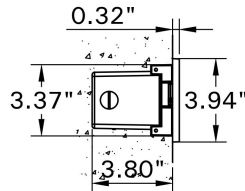
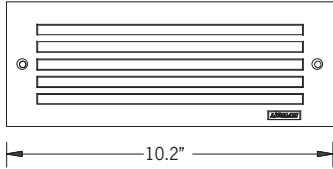

SUITABLE FOR WET LOCATIONS

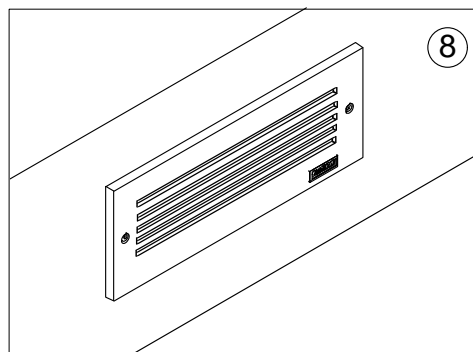
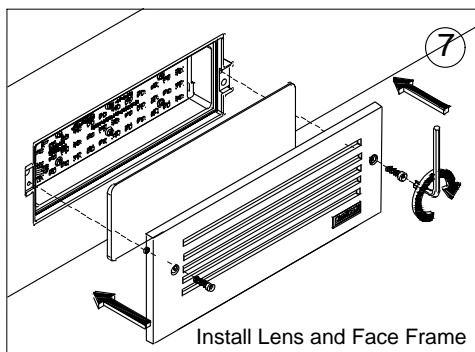
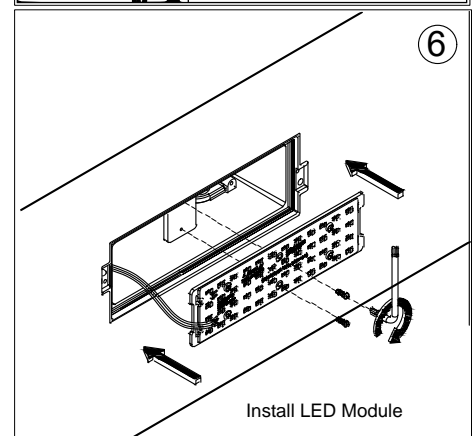
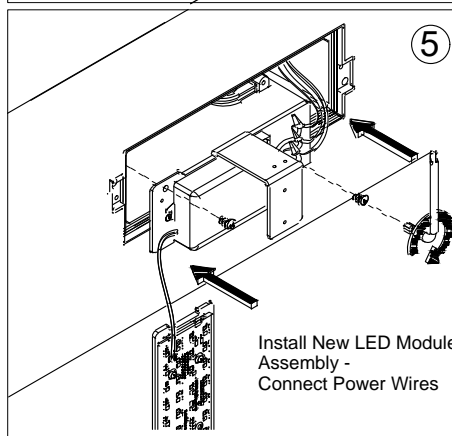
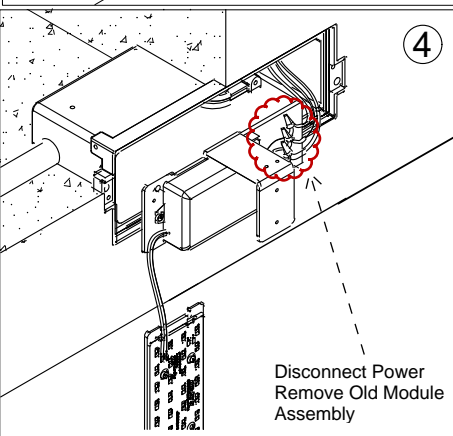
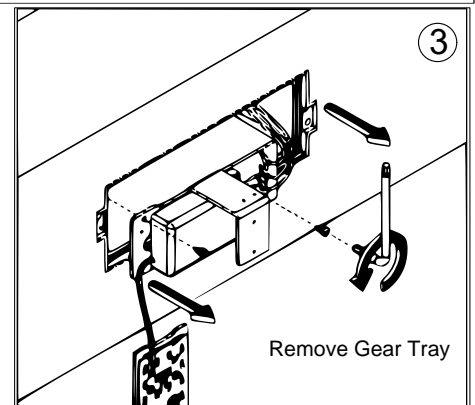
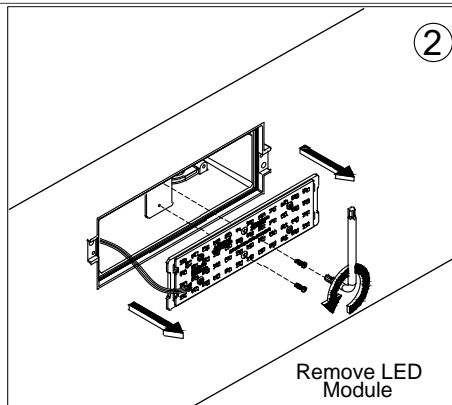
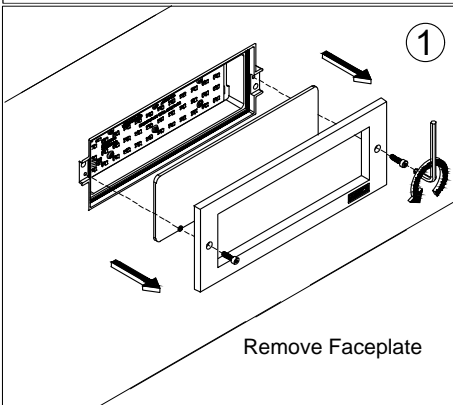
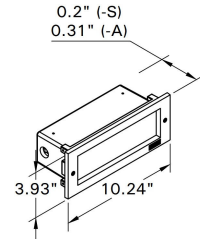

Notice to Installer

Wiring Instruction ⚠ Warning:

- Risk of Fire and Electrical Shock, This fixture must be installed only by a qualified electrician, Installation must adhere to the National Electrical Code (NEC) and all applicable local and federal regulations.
- Always disconnect power before servicing the fixture.

Ligman Lighting USA

7144 NE Progress Court, Hillsboro
Oregon, 97124, USA
Tel : 503 645 0500