

# INSTALLATION AND SERVICE MANUAL

For Installation of Gino 1,2 Wall Down and Up-Down Light LED.  
Model. UGI-31582, UGI-3183, UGI-31584, UGI-31592 and UGI-31593.

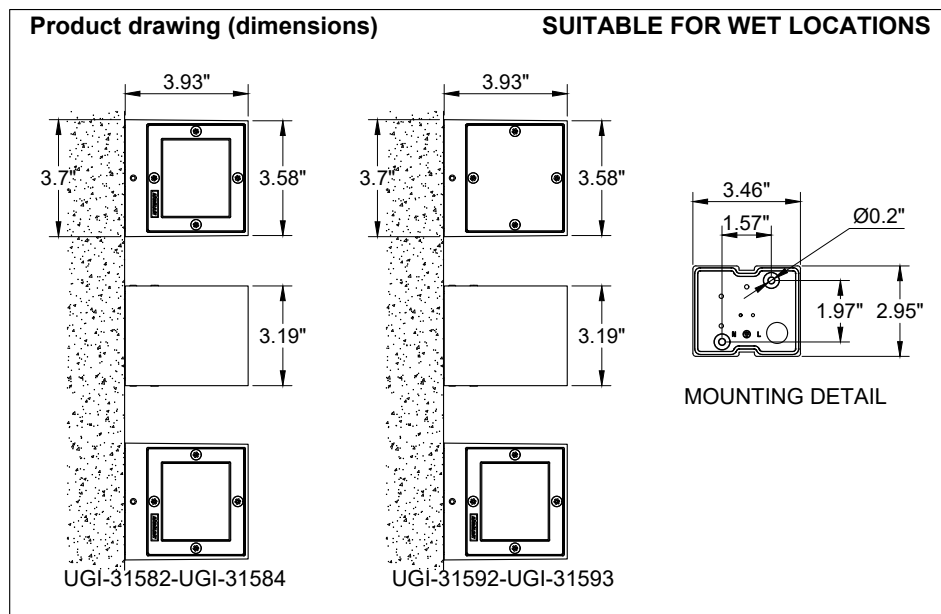

**NOTE** Mounts over Junction box.

1

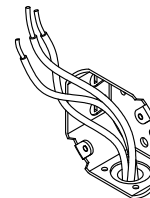

2

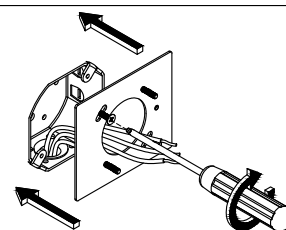

Position the body over the J Box and  
Secure the back plate to the wall

3

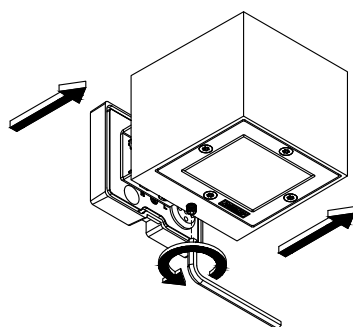

4

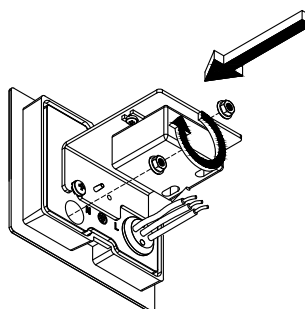

5

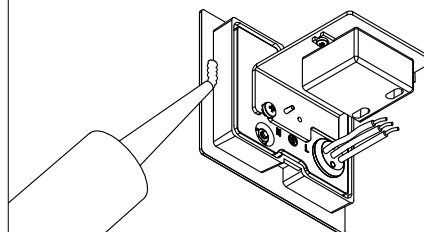

Ensure watertight seal using UL  
approved silicone based sealant.

6

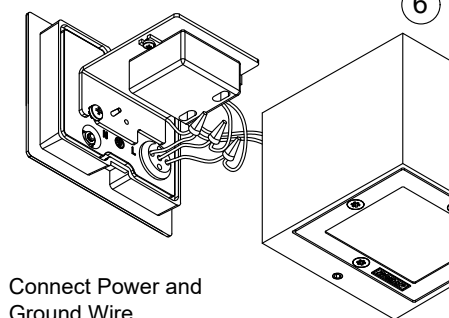

Connect Power and  
Ground Wire.

7

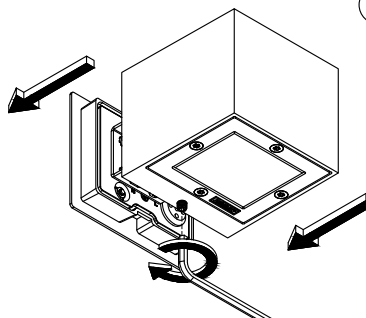

8

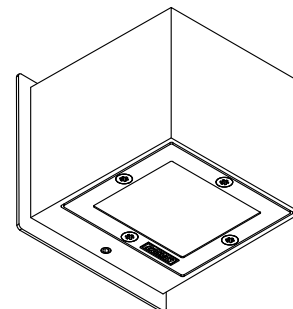

## Notice to installer :

**1.WIRING INSTRUCTIONS Warning : RISK OF FIRE AND ELECTRICAL SHOCK. : FIXTURE MUST BE INSTALLED BY A QUALIFIED ELECTRICIAN ONLY>FIXTURE IS INTENDED FOR INSTALLATION IN ACCORDANCE WITH THE NATIONAL ELECTRICAL CODE, LOCAL AND FEDERAL CODE SPECIFICATIONS. DISCONNECT POWER BEFORE SERVICING.**

**2.This fixture has a VOLTAGE SPECIFIC BALLAST,Check that the supply voltage is the same as the installed ballast voltage.**

**Ligman Lighting**

7144 NE Progress Court, Hillsboro  
Oregon, 97124, USA  
Tel : 503 645 0500 | Fax : 503 645 8100

[www.ligmanlightingusa.com](http://www.ligmanlightingusa.com)

UGI-31582 20-07-24 REV.1  
1/1

FM-TS-13-1/13-05-2563/Rev.6