

# INSTALLATION AND SERVICE MANUAL

**LIGMAN**  
LIGHTING USA

For Installation of Capsule surface  
Model. UCA-30305,UCA-30325,UCA-30596,UCA-30606

## Product drawing (dimensions) SUITABLE FOR WET LOCATIONS

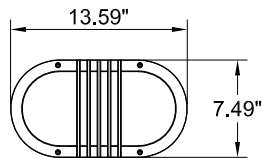

Capsule Surface 1  
UCA-30305

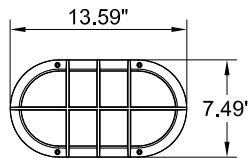
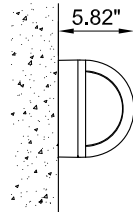

Capsule Surface 4  
UCA-30596

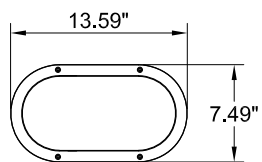
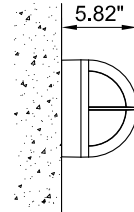

Capsule Surface 3  
UCA-30325

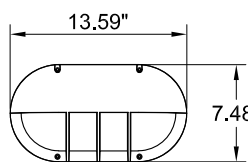
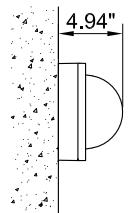

Capsule Surface 5  
UCA-30606

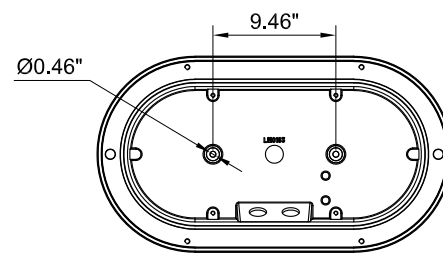
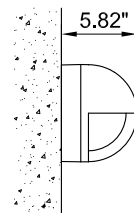

MOUNTING DETAIL

**NOTE**  
Mounts  
Junction box.

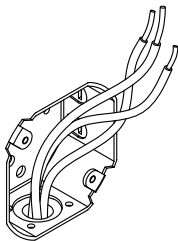

1

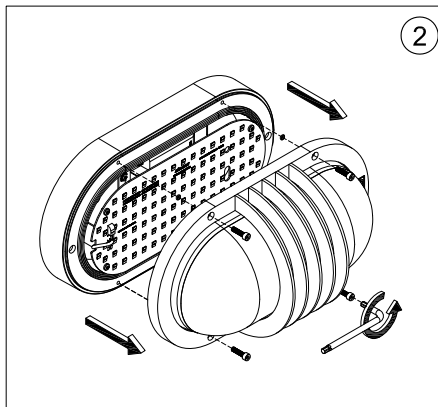

2

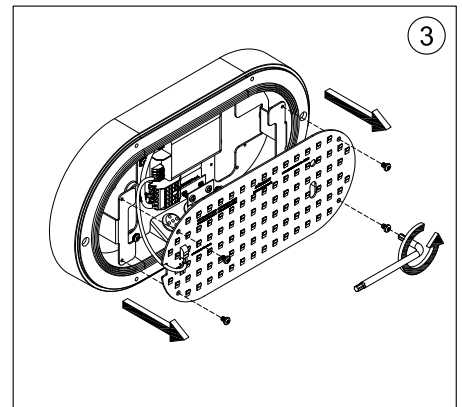

3

### Notice to installer :

- 1.WIRING INSTRUCTIONS** Warning : RISK OF FIRE AND ELECTRICAL SHOCK. : FIXTURE MUST BE INSTALLED BY A QUALIFIED ELECTRICIAN ONLY>FIXTURE IS INTENDED FOR INSTALLATION IN ACCORDANCE WITH THE NATIONAL ELECTRICAL CODE, LOCAL AND FEDERAL CODE SPECIFICATIONS. DISCONNECT POWER BEFORE SERVICING.
- 2.This fixture has a VOLTAGE SPECIFIC BALLAST,Check that the supply voltage is the same as the installed ballast voltage.**

**Ligman Lighting USA**

7144 NE Progress Court, Hillsboro  
Oregon, 97124, USA  
Tel : 503 645 0500 | Fax : 503 645 8100

[www.ligmanlightingusa.com](http://www.ligmanlightingusa.com)

UCA-30305 21/03/24 REV.3  
1/2

FM-TS-13-1/13-05-2563/Rev.6

