



# Syndy symmetrical indirect light wall light

IP65 ⚡⚡/EN 60598/CLASS I ⚡/V/CE/IK09



## Suitable for wet locations

A decorative wall lantern with excellent downward symmetrical light distribution and visual appeal. The precision optical system gives very low glare rating, while reducing light pollution. Developed to compliment Syndy indirect post top and street lanterns. Designed for lighting of entrances, footpaths and car parks. The LED luminaires have features such as long life, limited maintenance and constant lifetime performance.

Low copper content die-cast aluminum housing with high corrosion resistance. Stainless steel screws. Durable silicone rubber gasket and clear toughened glass. Housing is treated with a chemical chromated protection before powder coating, ensuring high corrosion resistance. Integral control gear. White painted aluminum reflector on the top of luminaire.

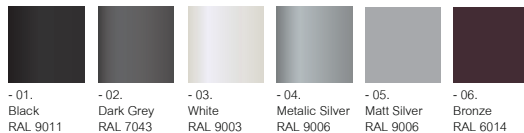

## Product Family





USY-30911

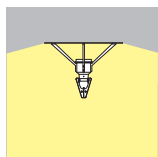

### Syndy symmetrical indirect light wall light

Model No.	Lamp	Holder	Lumen	Weight	Picture
USY-30911	T6 CMH 70w.	G12	5600	25.3 lb.	1
USY-30912	T6 CMH 100w.	G12	76000	26.5 lb.	1
USY-30913	T6 CMH 150w.	G12	11500	26.5 lb.	1
USY-30914	T6 CMH 70w.	G12	5600	28.5 lb.	3
USY-30915	T6 CMH 100w.	G12	76000	29.7 lb.	3
USY-30916	T6 CMH 150w.	G12	11500	29.7 lb.	3

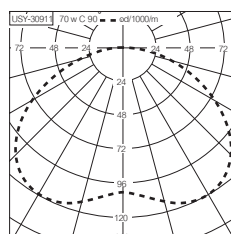
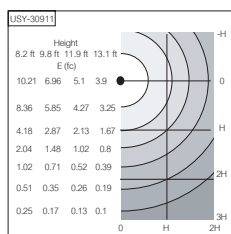

USY-30914

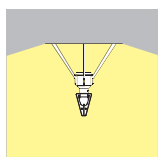

### Syndy indirect light wall light LED

Model No.	Lamp	Light output	LED colour	Power W	Beam	Weight	Picture	Dimmable 1 - 10V
USY-30917-W27	1 LED	1640 lm	2700K	41	121°	29.9 lb.	2	•
USY-30917-W30	1 LED	1745 lm	3000K	41	121°	29.9 lb.	2	•
USY-30917-W40	1 LED	1871 lm	4000K	41	121°	29.9 lb.	2	•
USY-30918-W27	1 LED	1640 lm	2700K	41	121°	31.1 lb.	4	•
USY-30918-W30	1 LED	1745 lm	3000K	41	121°	31.1 lb.	4	•
USY-30918-W40	1 LED	1871 lm	4000K	41	121°	31.1 lb.	4	•

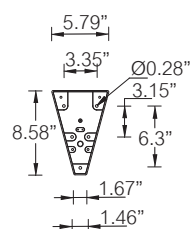
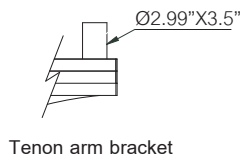

Mounting detail

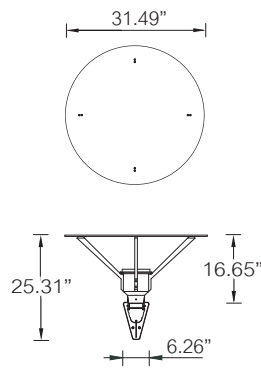
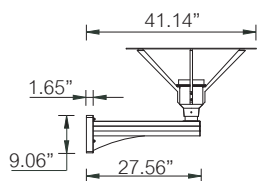

Picture 1

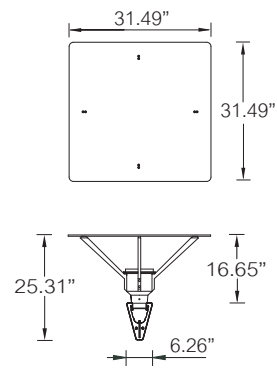

Picture 3

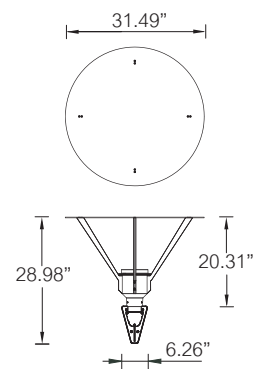

Picture 2

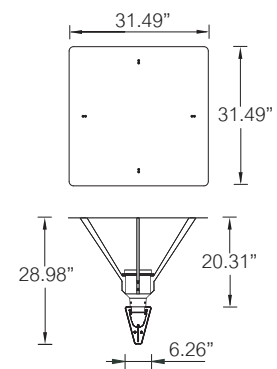

Picture 4

# Syndy oval asymmetrical indirect light wall light

IP65 ⬡⬡⬡/EN 60598/CLASS I ⚡/V/CE/IK09



## Suitable for wet locations

A decorative wall lantern with excellent downward indirect asymmetrical light distribution and visual appeal. The precision optical system gives very low glare rating while reducing light pollution. Developed to compliment Syndy oval indirect post top and street lanterns. Designed for lighting of entrances, footpaths and car parks. The luminaires have features such as long life, limited maintenance and constant lifetime performance.

Low copper content die-cast aluminum housing with high corrosion resistance. Stainless steel screws. Durable silicone rubber gasket and clear toughened glass. Housing is treated with a chemical chromatized protection before powder coating, ensuring high corrosion resistance. Integral control gear. White painted aluminum reflector on the top of luminaire. Remote control gear installed inside arm bracket. Anodized high purity aluminum internal reflector.



- 01. Black RAL 9011	- 02. Dark Grey RAL 7043	- 03. White RAL 9003	- 04. Metalic Silver RAL 9006	- 05. Matt Silver RAL 9006	- 06. Bronze RAL 6014

## Product Family





USY-30921

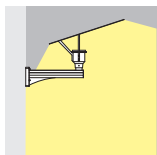

### Syndy oval

Model No.	Lamp	Holder	Lumen	Weight
USY-30921	T6 CMH 70w.	G12	5600	25.3 lb.
USY-30922	T6 CMH 100w.	G12	76000	26.5 lb.
USY-30923	T6 CMH 150w.	G12	11500	26.5 lb.

### Syndy oval indirect light wall light LED

Model No.	Lamp	Light output	LED colour	Power W	Beam	Weight	Dimmable 1 - 10V
USY-30924-W27	1 LED	1529 lm	2700K	41	121°	26.5 lb.	•
USY-30924-W30	1 LED	1626 lm	3000K	41	121°	26.5 lb.	•
USY-30924-W40	1 LED	1840 lm	4000K	41	121°	26.5 lb.	•

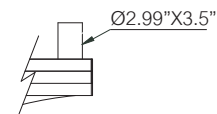
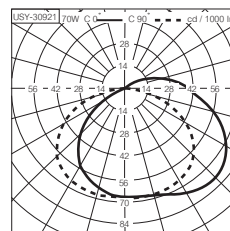
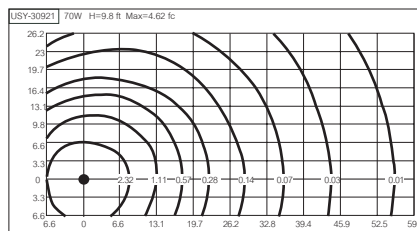

Tenon arm bracket

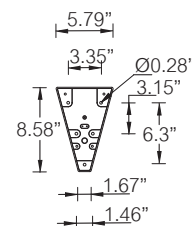
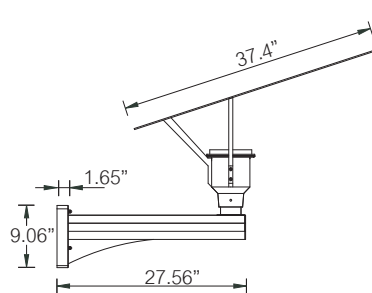
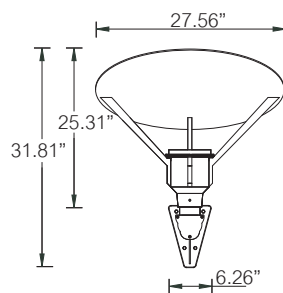

Mounting detail



Thomastown Recreation & Aquatic Center, VIC - Australia