

For Installation of Leeds medium and large wall surface down & up-down light LED.
Model. ULEE-30011, ULEE-30021, ULEE-30041 and ULEE-30051.

Product drawing (dimensions)

SUITABLE FOR WET LOCATIONS

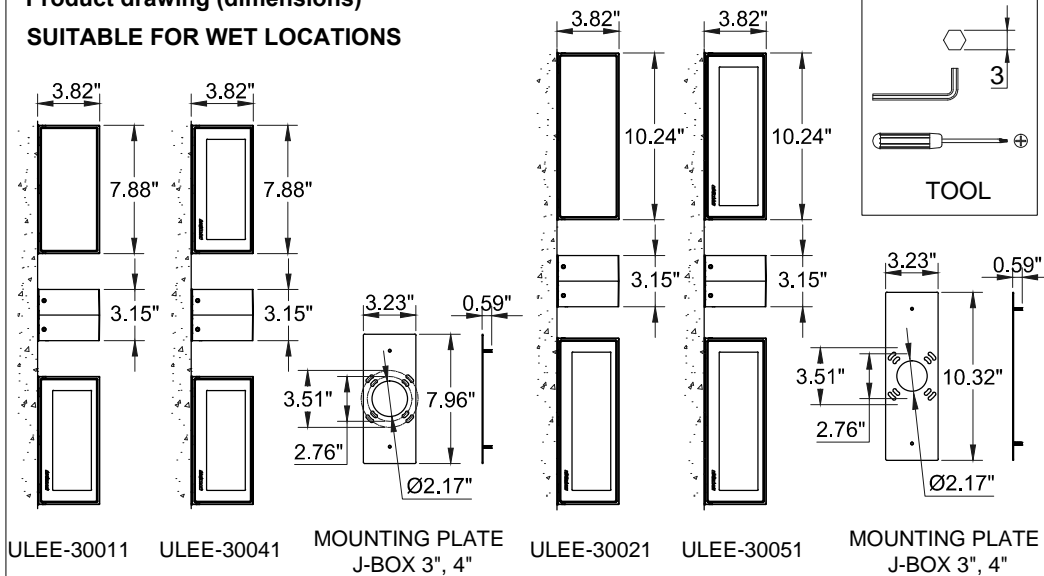

NOTE Mounts over a 3" Octagonal Junction box.

1

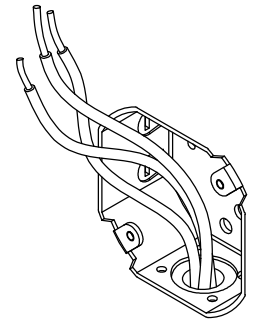

Position the body over the J Box and Secure the back plate to the wall

2

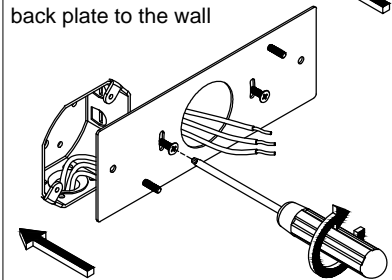

3

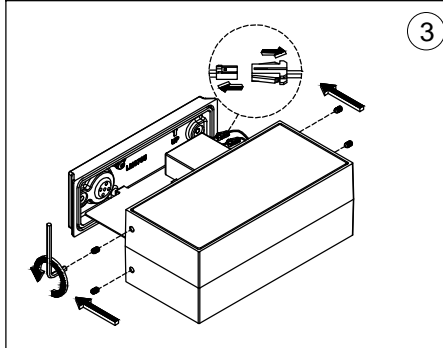

4

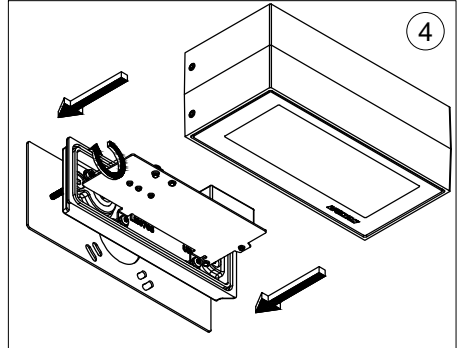

Connect power and Ground wire

5

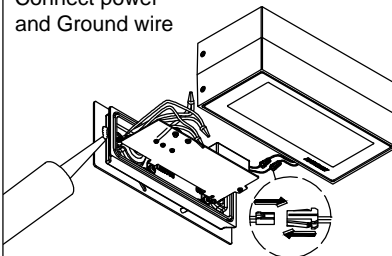

Ensure watertight seal using UL approved silicone based sealant.

6

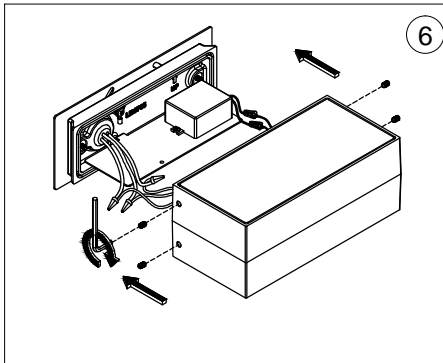

7

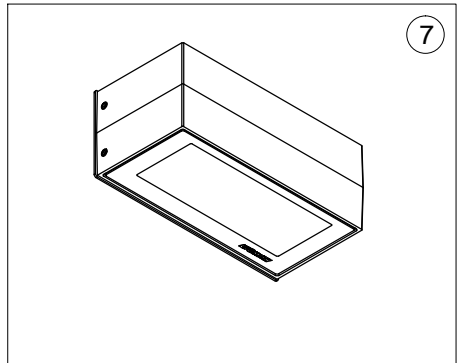

Notice to installer :

- 1.WIRING INSTRUCTIONS** Warning : RISK OF FIRE AND ELECTRICAL SHOCK. : FIXTURE MUST BE INSTALLED BY A QUALIFIED ELECTRICIAN ONLY>FIXTURE IS INTENDED FOR INSTALLATION IN ACCORDANCE WITH THE NATIONAL ELECTRICAL CODE, LOCAL AND FEDERAL CODE SPECIFICATIONS. DISCONNECT POWER BEFORE SERVICING.
- 2.This fixture has a VOLTAGE SPECIFIC BALLAST**,Check that the supply voltage is the same as the installed ballast voltage.

Ligman Lighting USA

7144 NE Progress Court, Hillsboro
Oregon, 97124, USA
Tel : 503 645 0500 | Fax : 503 645 8100

www.ligmanlightingusa.com



FM-TS-13/25-05-2007-REV.2