

# INSTALLATION AND SERVICE MANUAL

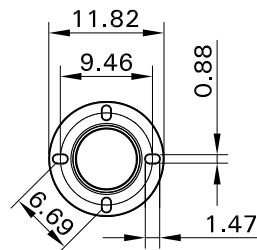

For installation of Arizona Light Column dia 6.3" LED.  
Model. UAR-21011-21012.

## Product drawing (dimensions) SUITABLE FOR WET LOCATIONS

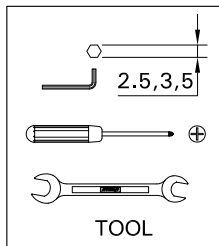
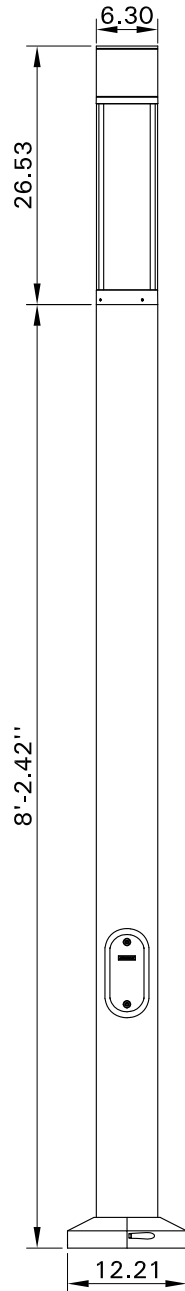

MOUNTING DETAIL

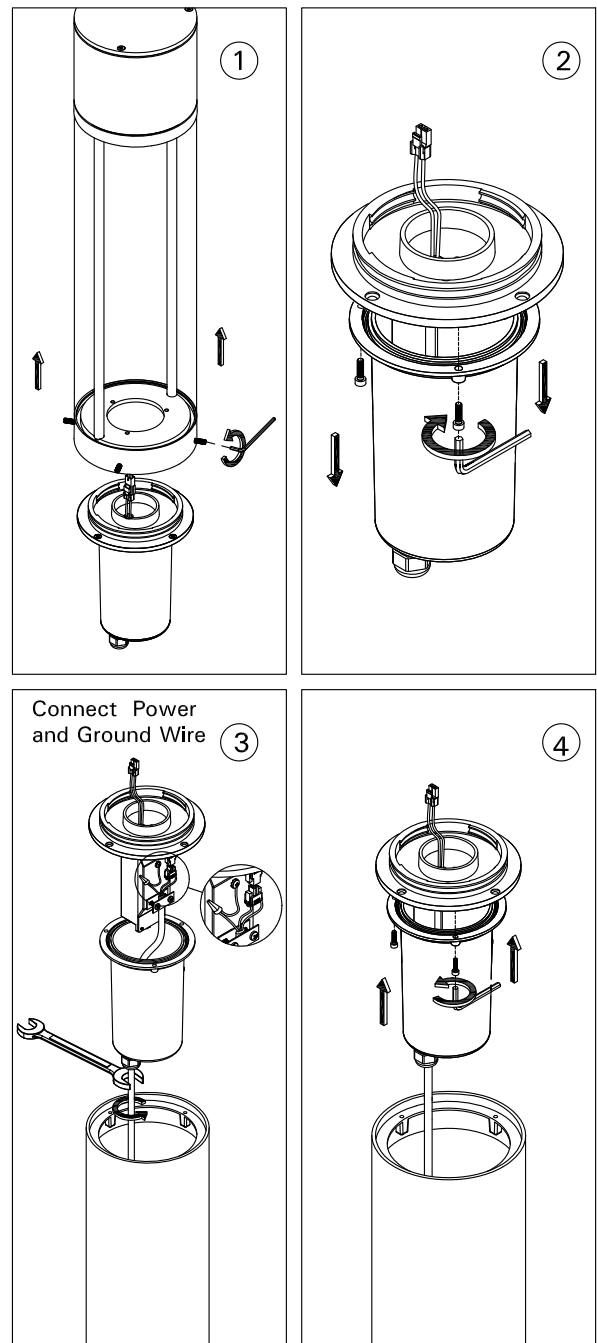

### Notice to installer :

- 1.WIRING INSTRUCTIONS** Warning : RISK OF FIRE AND ELECTRICAL SHOCK. : FIXTURE MUST BE INSTALLED BY A QUALIFIED ELECTRICIAN ONLY>FIXTURE IS INTENDED FOR INSTALLATION IN ACCORDANCE WITH THE NATIONAL ELECTRICAL CODE, LOCAL AND FEDERAL CODE SPECIFICATIONS. DISCONNECT POWER BEFORE SERVICING.
- 2.This fixture has a VOLTAGE SPECIFIC BALLAST,Check that the supply voltage is the same as the installed ballast voltage.**

## Ligman Lighting USA

7144 NW Progress Court, Hillsboro  
Oregon, 97124, USA  
Tel : 503 645 0500 | Fax : 503 645 8100

[www.ligmanlightingusa.com](http://www.ligmanlightingusa.com)

UAR 21011 31/10/15/REV.0  
1/2



FM-TS-13/25-05-2007-REV.2

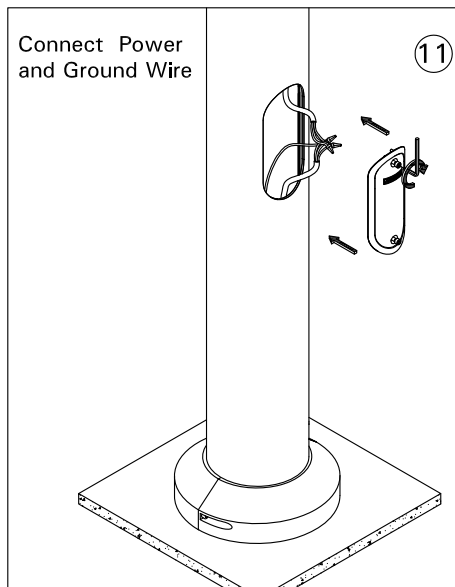
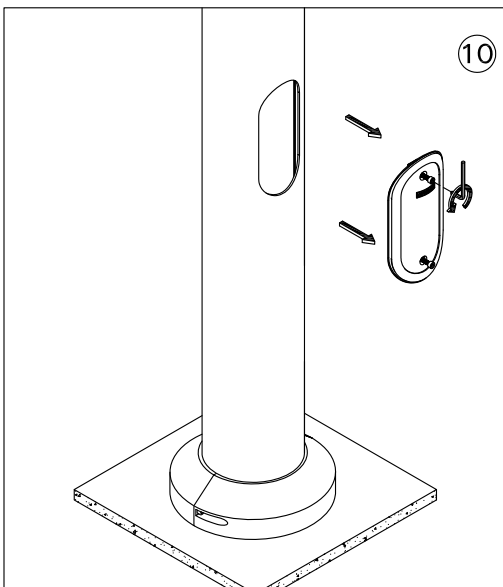
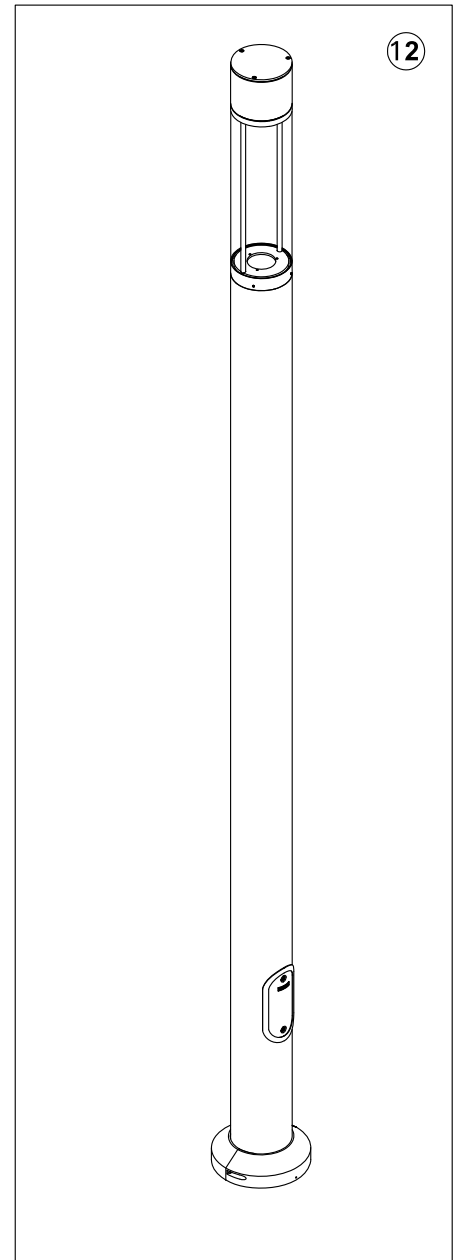
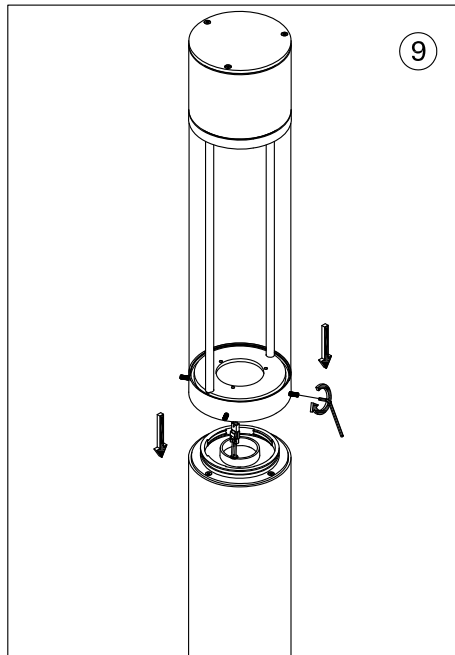
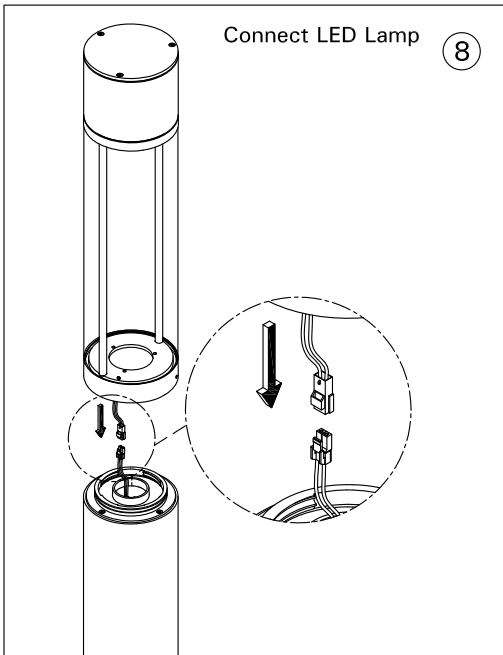
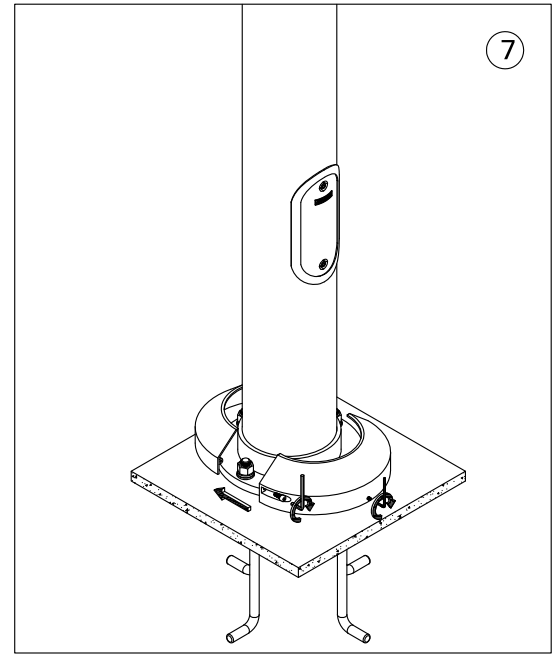
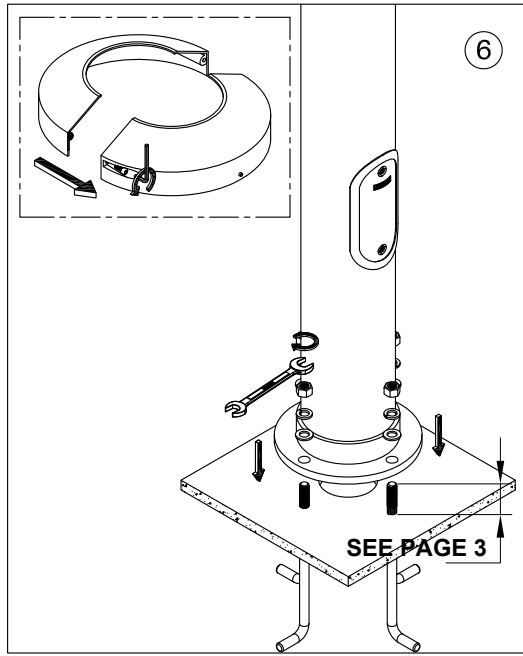
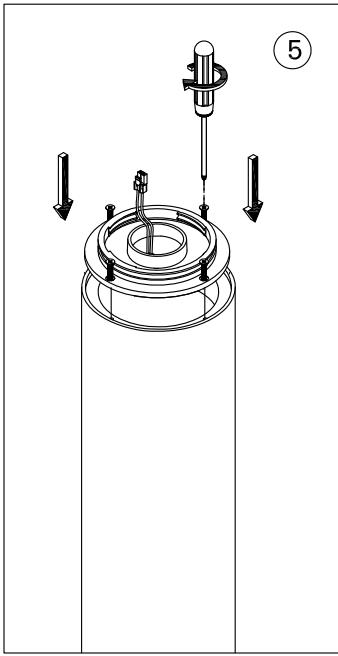

## USING LEVELING SHIMS

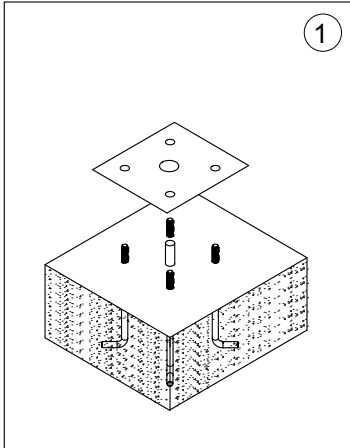

Use anchor bolt template to set anchor bolts into concrete as per civil engineering instructions.

**Ligman does not provide foundation details. A local engineer that is familiar with the site soil conditions should provide this information.**

### NOTE:

Ligman does not recommend using leveling bolts for pole installations.

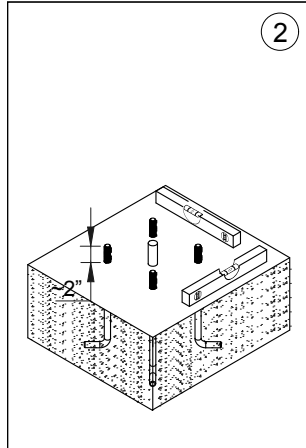

Ensure that the concrete is plumb using a level. Failing to do this will result in pole being uneven or tilted.

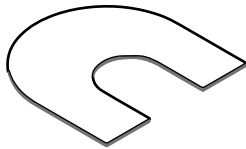

Leveling Shim Example

## What's Included Per Pole

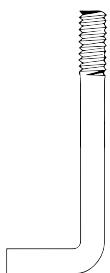

x 4

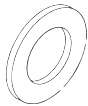
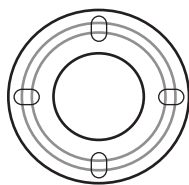

x 4

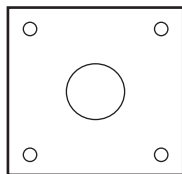

A single anchor bolt template is provided per pole size to be used for the poles on the project.

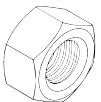

x 4

Anchor bolt template may be round or square dependant upon which pole is being used.

## USING LEVELING BOLTS

SHOULD THE CONTRACTOR SELECT TO USE THE LEVELING BOLT METHOD, AN ADDITIONAL 4 BOLTS NEED TO BE PURCHASED

In rare instances where leveling bolts have to be used, it is important that a flush concrete surface is created to mount the pole base plate.  
**NOTE: When using leveling bolts, bolt projection should be 3.5"**

### Using Leveling Bolts Option A

Note : Bolt cover stops flush with the pole base plate

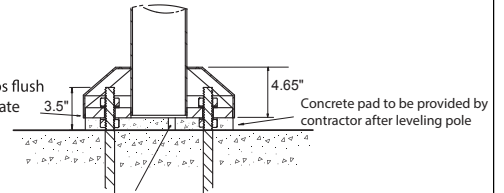

Slot to be provided in concrete to allow water to drain

When using leveling bolts.

After establishing a level platform the space between the original concrete surface and the pole base should be filled with concrete and finished flush.

This provides a uniform load displacement pad for the forces created by wind and luminaire weight

Foundation and Design by Others

### Using Leveling Bolts Option B

Note : Bolt cover stops flush with the pole base plate

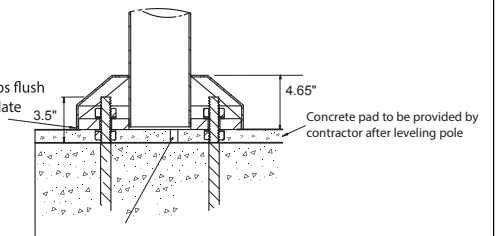

Slot to be provided in concrete to allow water to drain

When using leveling bolts.

After establishing a level platform the space between the original concrete surface and the pole base should be filled with concrete and finished flush.

This provides a uniform load displacement pad for the forces created by wind and luminaire weight