

For installation of Legend Recessed step light LED.
Model. ULE-40721 and ULE-40722.

Product drawing (dimensions)

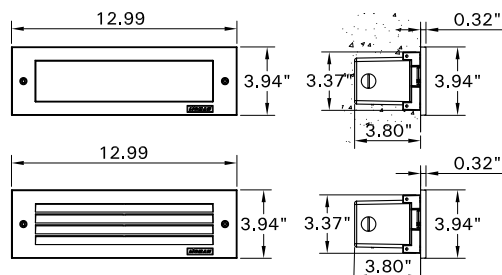

SUITABLE FOR WET LOCATIONS

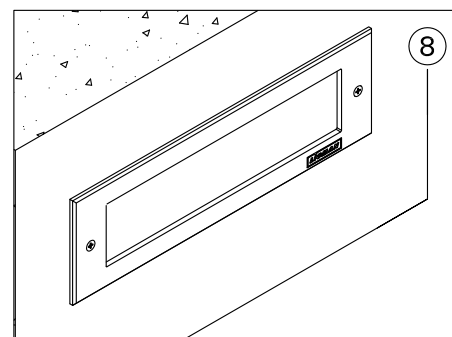
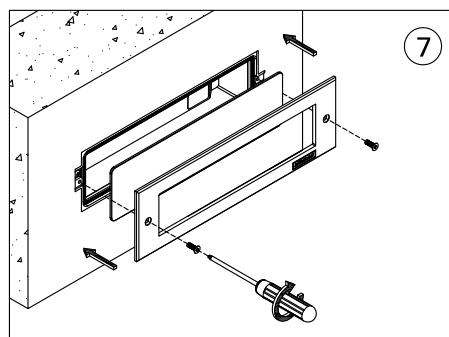
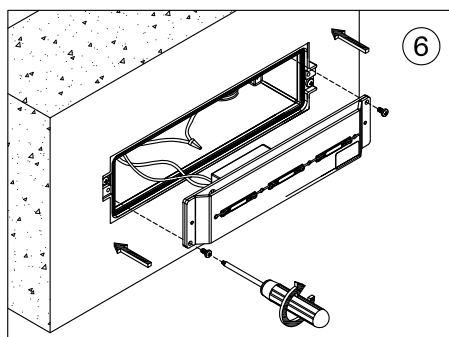
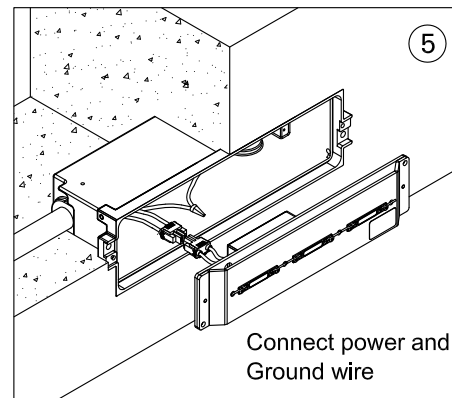
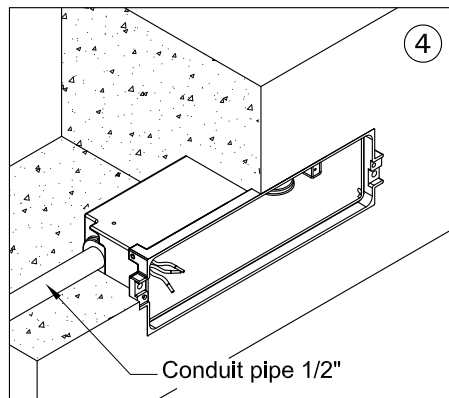
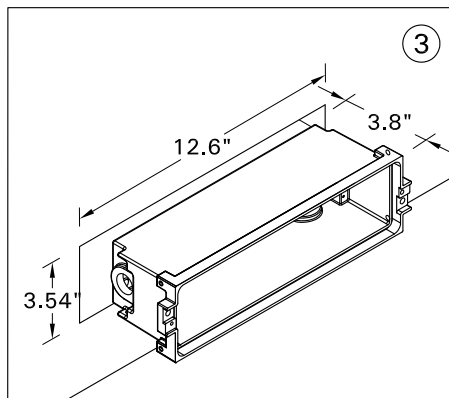
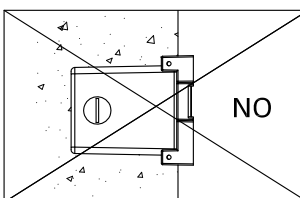
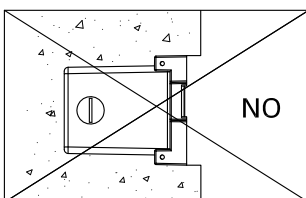
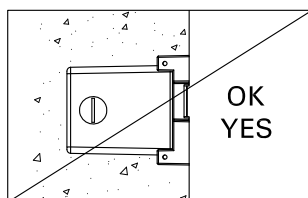
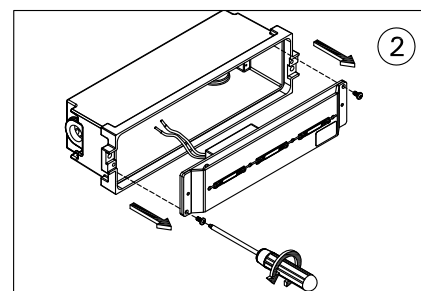
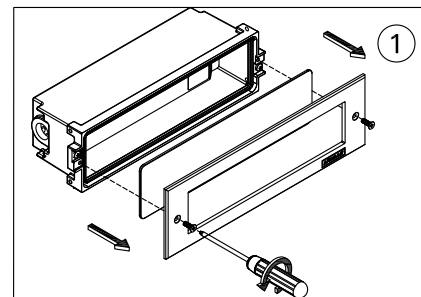
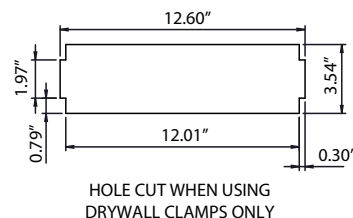

Notice to installer :

- 1.WIRING INSTRUCTIONS** Warning : RISK OF FIRE AND ELECTRICAL SHOCK. : FIXTURE MUST BE INSTALLED BY A QUALIFIED ELECTRICIAN ONLY>FIXTURE IS INTENDED FOR INSTALLATION IN ACCORDANCE WITH THE NATIONAL ELECTRICAL CODE, LOCAL AND FEDERAL CODE SPECIFICATIONS. DISCONNECT POWER BEFORE SERVICING.
- 2.This fixture has a VOLTAGE SPECIFIC DRIVER,Check that the supply voltage is the same as the installed driver voltage.**

Ligman Lighting USA

7144 NW Progress Court, Hillsboro
Oregon, 97124, USA
Tel : 503 645 0500 | Fax : 503 645 8100

www.ligmanlightingusa.com

ULE-40721 16/10/15/REV.0
1/1



FM-TS-13/25-05-2007-REV.2