

INSTALLATION AND SERVICE MANUAL



For installation of Vektor 7,8 Arm Bracket wall Light.
Model. UVK-30011-30012 and UVK-30031-30032.

Product drawing (dimensions)

SUITABLE FOR WET LOCATIONS

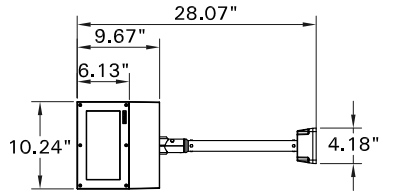
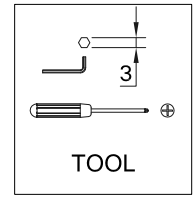

UVK-30011-30012

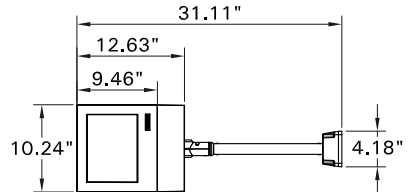

UVK-30031-30032

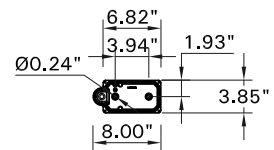

MOUNTING DETAIL

NOTE

Mounts over a 3" Octagonal Junction box.

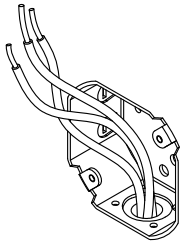

①

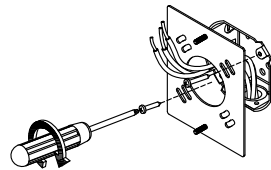

Position the body over the J Box and Secure the back plate to the wall

②

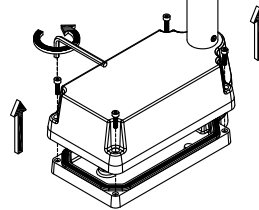

③

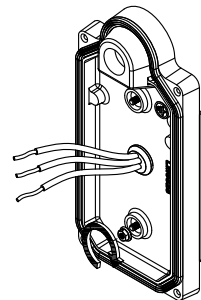

④

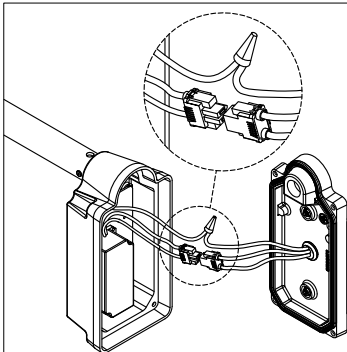

Connect power And Ground wire

⑤

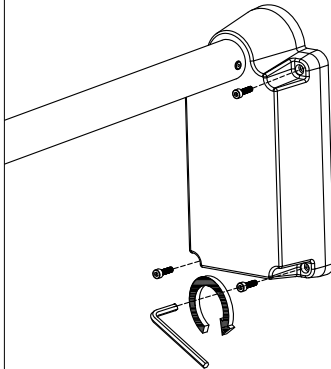

⑥

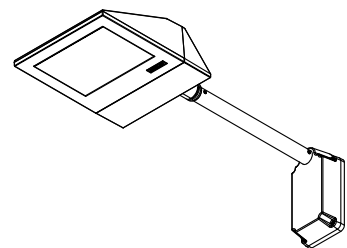

⑦

Notice to installer :

- 1.WIRING INSTRUCTIONS** Warning : RISK OF FIRE AND ELECTRICAL SHOCK. : FIXTURE MUST BE INSTALLED BY A QUALIFIED ELECTRICIAN ONLY>FIXTURE IS INTENDED FOR INSTALLATION IN ACCORDANCE WITH THE NATIONAL ELECTRICAL CODE, LOCAL AND FEDERAL CODE SPECIFICATIONS. DISCONNECT POWER BEFORE SERVICING.
- 2.This fixture has a VOLTAGE SPECIFIC BALLAST,**Check that the supply voltage is the same as the installed ballast voltage.

Ligman Lighting USA

7144 NW Progress Court, Hillsboro
Oregon, 97124, USA
Tel : 503 645 0500 | Fax : 503 645 8100

www.ligmanlightingusa.com

ISO 9001
ISO 14001
BUREAU VERITAS
Certification



FM-TS-13/25-05-2007-REV.2