

# INSTALLATION AND SERVICE MANUAL

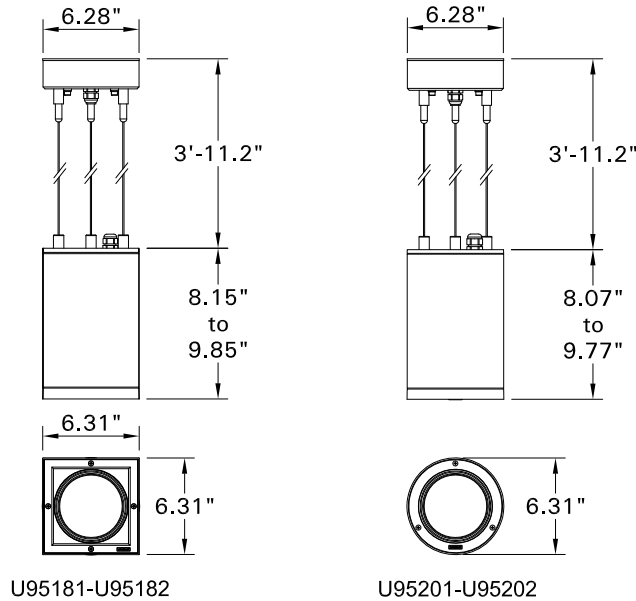

For installation of Tango 17,19 pendant luminaire round dia 160mm. and square 160mm.  
Model. U95181-U95182 and U95201-U95202.

## Product drawing (dimensions)



## SUITABLE FOR WET LOCATIONS

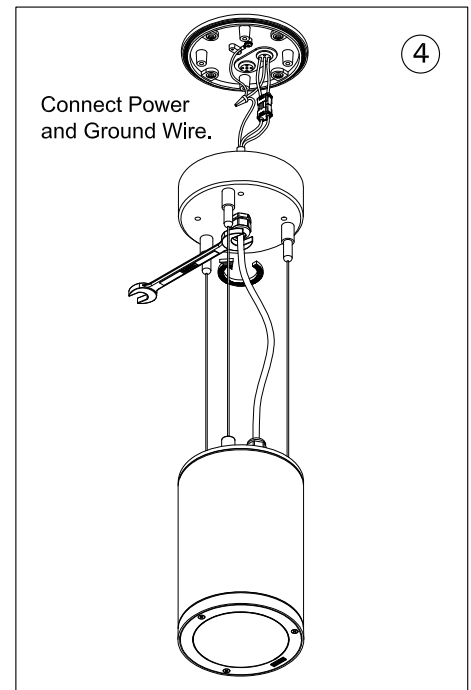
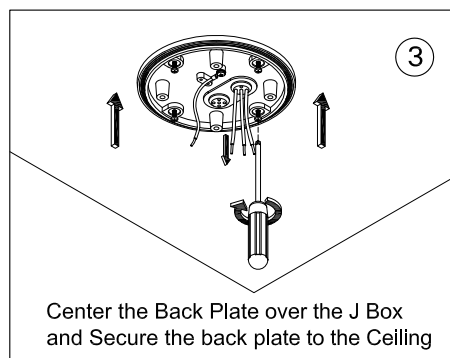
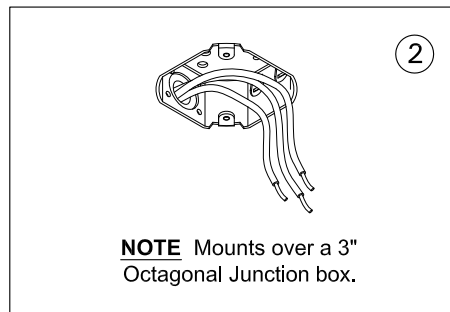
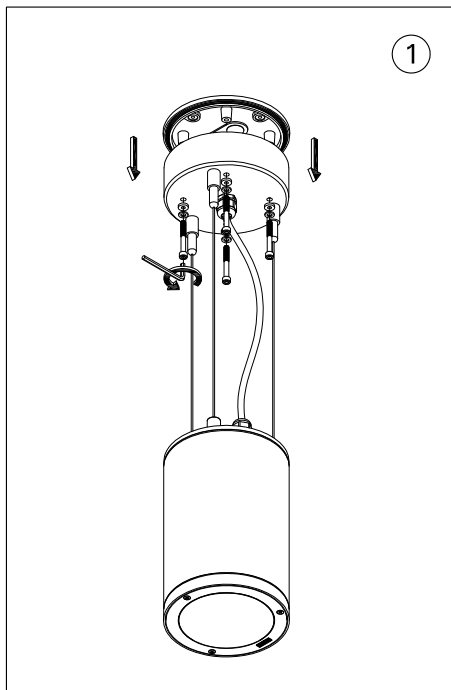
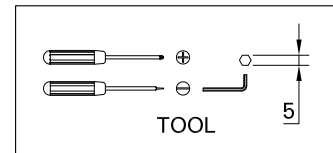
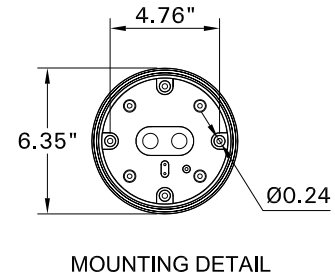

## Notice to installer :

- 1.WIRING INSTRUCTIONS** Warning : RISK OF FIRE AND ELECTRICAL SHOCK. : FIXTURE MUST BE INSTALLED BY A QUALIFIED ELECTRICIAN ONLY>FIXTURE IS INTENDED FOR INSTALLATION IN ACCORDANCE WITH THE NATIONAL ELECTRICAL CODE, LOCAL AND FEDERAL CODE SPECIFICATIONS. DISCONNECT POWER BEFORE SERVICING.
- 2.This fixture has a VOLTAGE SPECIFIC BALLAST**,Check that the supply voltage Is the same as the Installed ballast voltage.

## Ligman Lighting USA

Tanasbourne Commerce Center  
3302 Nw 211th Terrace  
Hillsboro Oregon 97124  
Tel : 503-645-0500, Fax : 503-645-8100

www.ligmanlightingusa.com

U 95181/30/01/12/REV.0

1/1



FM-TS-13/25-05-2007-REV.2

