

INSTALLATION AND SERVICE MANUAL

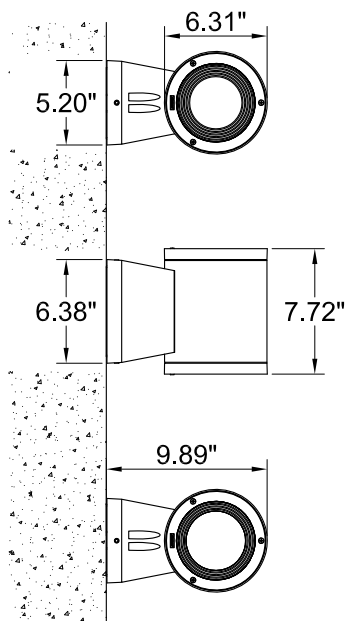

For installation of Tango 1,11 cylindrical and square Wall up-down light.
Model. UTA-30403 and UTA-30722.

Product drawing (dimensions)



UTA-30403

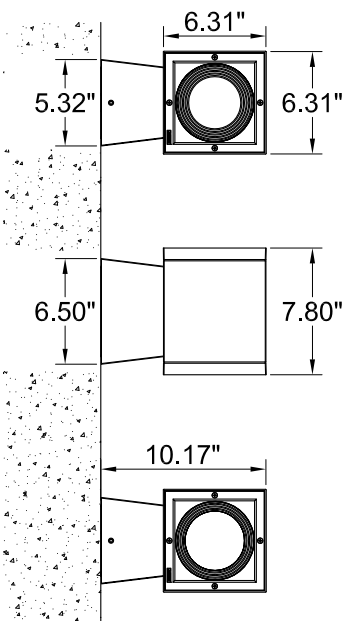

UTA-30722

SUITABLE FOR WET LOCATIONS

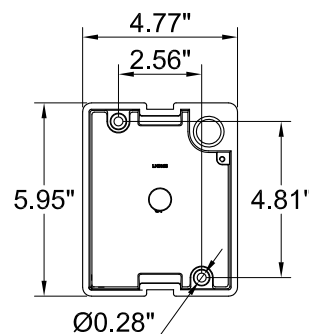
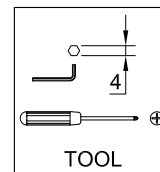

MOUNTING DETAIL

NOTE

Mounts over
a 3"Octagonal
Junction box.

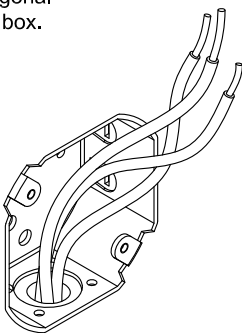

①

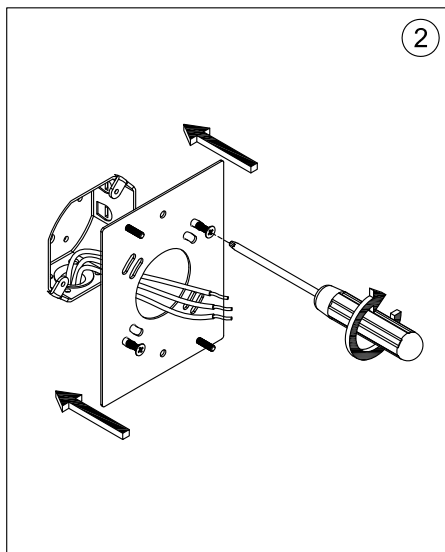

②

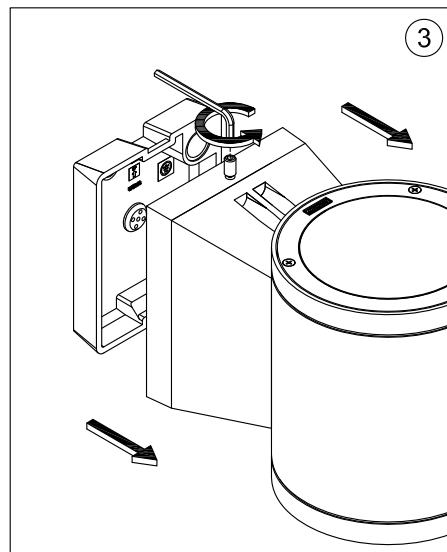

③

Notice to installer :

1. **WIRING INSTRUCTIONS** Warning : RISK OF FIRE AND ELECTRICAL SHOCK. : FIXTURE MUST BE INSTALLED BY A QUALIFIED ELECTRICIAN ONLY>FIXTURE IS INTENDED FOR INSTALLATION IN ACCORDANCE WITH THE NATIONAL ELECTRICAL CODE, LOCAL AND FEDERAL CODE SPECIFICATIONS. DISCONNECT POWER BEFORE SERVICING.
2. This fixture has a **VOLTAGE SPECIFIC BALLAST**, Check that the supply voltage is the same as the installed ballast voltage.

Ligman Lighting USA

7144 NW Progress Court, Hillsboro
Oregon, 97124, USA
Tel : 503 645 0500 | Fax : 503 645 8100

www.ligmanlightingusa.com

UTA-30403/13/06/14/REV.2
1/2



FM-TS-13/25-05-2007-REV.2

Center the Back Plate over the J Box and Secure the back plate to the wall

4

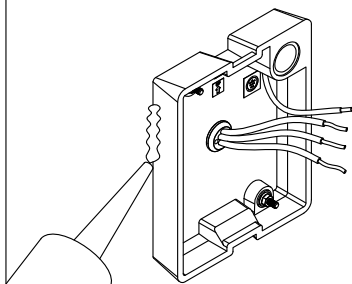

Ensure watertight seal using UL approved silicone based sealant.

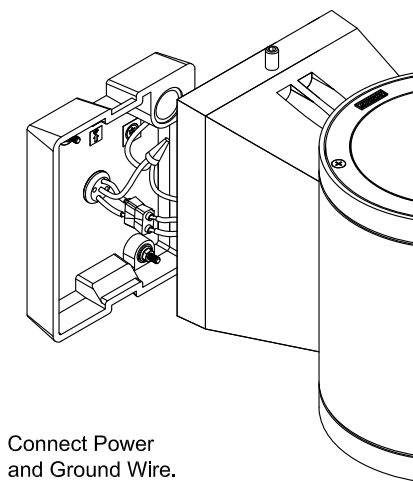

Connect Power and Ground Wire.

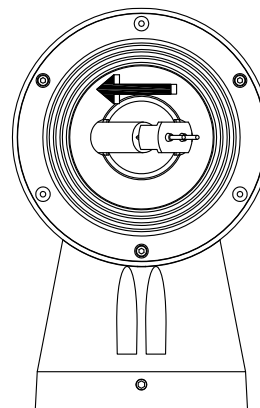
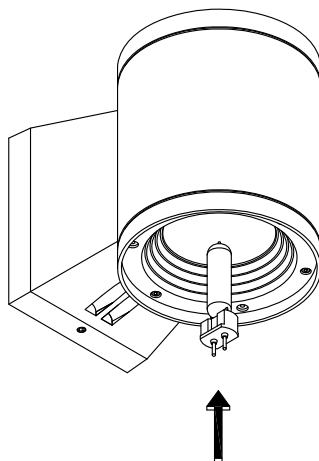
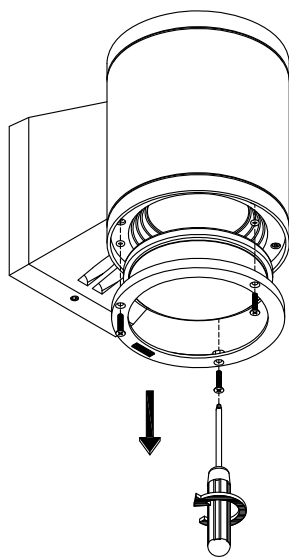
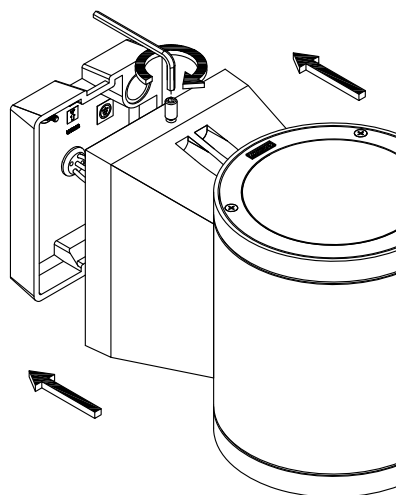

Install Lamp

