

For installation of Gino 1,2 wall down and up-down light.
Model. UGI-31071 and UGI-31081.

Product drawing (dimensions)

SUITABLE FOR WET LOCATIONS

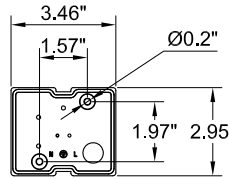
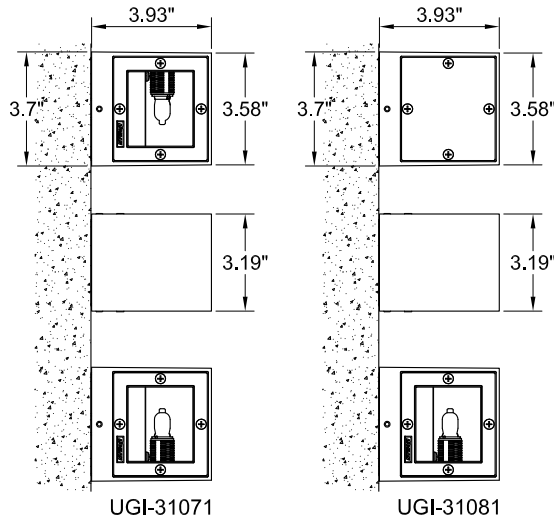

MOUNTING DETAIL

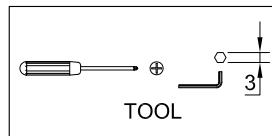

TOOL

NOTE Mounts over
a 3" Octagonal
Junction box.

1

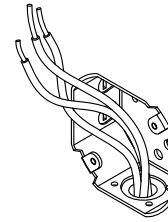

2

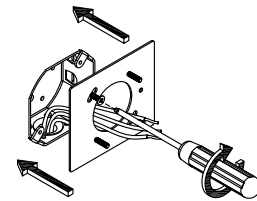

Position the body over the J Box and
Secure the back plate to the wall

3

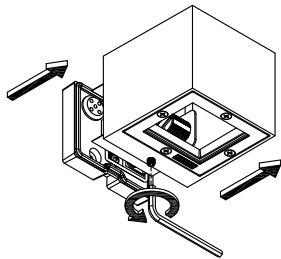

4

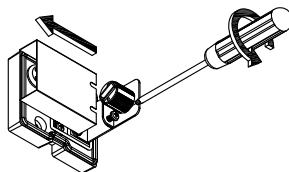

5

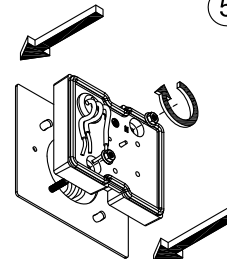

6

Connect Power and
Ground Wire.

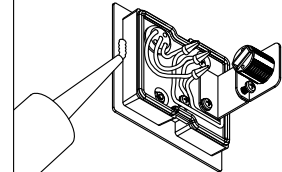

Ensure watertight seal using UL
approved silicone based sealant.

7

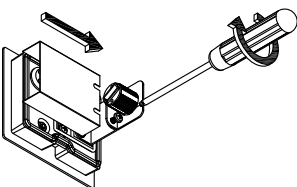

8

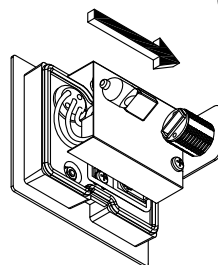

Install lamp

9

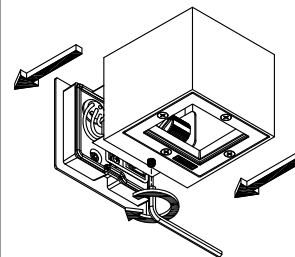

10

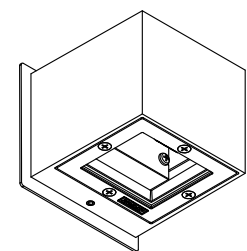

Notice to installer :

- 1.WIRING INSTRUCTIONS** Warning : RISK OF FIRE AND ELECTRICAL SHOCK. : FIXTURE MUST BE INSTALLED BY A QUALIFIED ELECTRICIAN ONLY>FIXTURE IS INTENDED FOR INSTALLATION IN ACCORDANCE WITH THE NATIONAL ELECTRICAL CODE, LOCAL AND FEDERAL CODE SPECIFICATIONS. DISCONNECT POWER BEFORE SERVICING.
- 2.This fixture has a VOLTAGE SPECIFIC BALLAST,**Check that the supply voltage is the same as the installed ballast voltage.

Ligman Lighting USA

7144 NW Progress Court, Hillsboro
Oregon, 97124, USA
Tel : 503 645 0500 | Fax : 503 645 8100

www.ligmanlightingusa.com

UGI-31071/27/09/12/REV.0

1/1



FM-TS-13/25-05-2007-REV.2